



# I-TED 2011

INTERNATIONAL TRANSPORTATION ECONOMIC DEVELOPMENT CONFERENCE  
Economic Impact of Connecting People, Goods, Markets, Employment, Services and Production



**ECONOMY GLOBAL CONCERNS FINANCIAL CONSTRAINTS**

May 1-3, 2011 ♦ Charleston, West Virginia, USA

# Welcome to West Virginia

Dear ITED Participants,

As Director and CEO of the Rahall Transportation Institute, I would like to extend a warm welcome to all of our colleagues and guests who have traveled to West Virginia for the International Transportation and Economic Development Conference 2011.

The ITED Conference is the fourth international conference to bring together a variety of professionals from government, higher education, public and private industries, to concentrate on the link between transportation and economic development.

Through technical sessions, training opportunities, presentations of research and networking functions, participants will discuss and address the emerging transportation needs of business and economic development communities from local to global levels.

Special thanks are extended to our distinguished speakers and sponsors, whose generosity has made this conference possible. We are especially honored to have United States Secretary of Transportation Ray LaHood, who adds an immense amount of expertise to the ITED conference, to serve as our keynote speaker. The knowledge that he and our other distinguished speakers provide in the opening sessions help set the tone of the conference as a positive and progressive ground for participants to exchange ideas and create solutions for the transportation and economic development challenges that affect us all.

As a native West Virginian, I also encourage conference goers to explore our beautiful capital city and the surrounding area. Charleston is home to state government offices, Chesapeake Energy, Dow Chemical, Verizon, DuPont, the University of Charleston and West Virginia State University. Dozens of dining, shopping, outdoor and sporting event experiences await the Charleston visitor.

With kindest regards, I look forward to participating in the 2011 I-TED Conference with all of you.

Sincerely,



Bob Plymale  
Director and CEO, RTI





# Welcome to ITED

Welcome ITED Participants,

As Co-Chairmen of the fourth International Transportation and Economic Development Conference we welcome you to this important event dedicated to examining a wide variety of effects that transportation investments have on the economic development prospects of communities, regions and nations.

In this era of globalization it is evident that access to transportation services is vital to promote local, regional and national economic performance and competitiveness. Yet in this era, many communities and nations are reckoning with significant financial constraints when assessing when, where and how to make cost effective transportation infrastructure investments that promote maximum economic returns. This conference aims to shed light on these issues and contribute to international understanding of the effects of transportation investments on economic growth and performance. Another objective of this conference is to identify and promote new research topics and information sharing about a broad range of economic and social effects of transportation infrastructure investments on regional development.

The presenters and participants in conference plenaries and panels bring a breadth of expertise and experience from all over the world and span a considerable range of topics including trade and transportation, freight transportation and national economic development, climate change and energy efficiency in transportation, among others. Furthermore the conference presenters also seek to present new methods of project assessment and impact analysis to promote better decision-making in transportation investments in both public and private sector activities.

We wish to extend our special thanks to the Nick J. Rahall II Transportation Institute as the anchor sponsor, as well as the Appalachian Regional Commission, the Delta Regional Authority, the West Virginia Department of Transportation, the American Association of State Highway Transportation Officials, the National Association of Development Organizations, and the U.S. Department of Transportation, Federal Highway Administration. In addition, we must recognize the key role of the Transportation Research Board and the Committee on Transportation and Economic Development for organizing this conference. Furthermore, key private sector sponsors have also contributed to the formation and support of the conference including: Economic Development Research Group, The Louis Berger Group, Inc., Wilbur Smith Associates, and Cambridge Systematics.

Finally we are very glad to be holding this conference in the State of West Virginia and the Appalachian Region which has pioneered many efforts to understand the role of transportation in economic development. We look forward to working with you in the next few days to make the 2011 ITED conference a successful event.

Sincerely

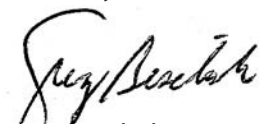

Greg Bischak



Christopher Mann

Co-Chairmen of the Transportation and Economic Development Committee  
Transportation Research Board

# Special Thanks

**Planning Committee** - Many individuals have come together to help make this event a success. In addition to those individuals speaking and moderating at the conference, we want to extend a special thank you to our conference committee:

Greg Bischak, US Department of the Treasury (Conference Chair)  
Chris Mann, TED Committee, TRB (Conference Co-Chair)

Andrew Nichols, Rahall Transportation Institute  
Peggy Tadej, Northern Virginia Regional Commission  
Martin Weiss, Martin Weiss Consultants  
Bethany Williams, Rahall Transportation Institute

## **The following individuals assisted by reviewing abstracts:**

Peggy Tadej, Northern Virginia Regional Commission (Abstract Review Chair)

Greg Bischak, US Department of the Treasury  
Junwook Chi, Rahall Transportation Institute  
Jim Gillespie, Virginia Department of Transportation  
Konstantina "Nadia" Gkritza, Iowa State University  
Kazuwa Kawamura, University of Illinois at Chicago  
Carrie Kissell, National Association of Development Organizations  
Marwan Madi, Booz Allen Hamilton  
Chris Mann, TED Committee, TRB  
Melissa Paciulli, University of Massachusetts Amherst  
Rimon Rafia, Economikr  
Jon Skolnik, Jack Faucett Associates, Inc.  
Sharada Vadali, Texas Transportation Institute  
Martin Weiss, Martin Weiss Consultants  
Glen Weisbrod, Economic Development Research Group



# Sponsors

## Platinum Sponsor



**APPALACHIAN  
REGIONAL  
COMMISSION**



AMERICAN ASSOCIATION OF  
STATE HIGHWAY AND  
TRANSPORTATION OFFICIALS

**AASHITO**  
THE VOICE OF TRANSPORTATION



**NADO**  
NATIONAL ASSOCIATION OF DEVELOPMENT ORGANIZATIONS



U.S. Department of Transportation  
Federal Highway Administration

## Gold Sponsor



## Silver Sponsor



THE Louis Berger Group, INC.

## Bronze Sponsor



**CAMBRIDGE**  
SYSTEMATICS

Transportation leadership you can trust.

## Endorsing Sponsor



Committee of the Transportation Research Board

**TED** Transportation  
and Economic  
Development

# Important Notes

**Assistance** - If you have questions or need assistance during the conference, please look for conference staff wearing nametags with red ribbons. They will be happy to assist you.

**Registration Desk** - The registration desk will be open all 3 days of the conference in the Pre-Conference area (see below for location). If you have questions regarding sessions or activity meeting times/places, please feel free to stop and ask for assistance. You can also phone us (toll-free) at 1-866-633-8110.

**Nametags** - Nametags allow attendees and guests entrance to all applicable conference sessions, meals and activities. Please have your nametag with you at all times.

**Activities** - If you wish to attend an activity, but did not sign up previously on your registration form, please speak to the staff at the registration desk. A limited number of seats are still available for some activities. However, attendance will be granted on a first-come, first-served basis.

**Professional Development Hours** - If you signed up to receive a PDH certificate you can pick those up at the registration desk at the close of the conference.

**Vendors** - The following companies/organizations will have informational displays at the conference on Monday, May 2nd through Tuesday, May 3rd: Appalachian Regional Commission, Economic Development Research Group, National Association of Development Organizations, Rahall Transportation Institute, and Regional Economic Models, Inc.

**Proceedings** - Presentations from the conference will be made available on the conference website - <http://www.ited2011.org>. It is anticipated that presentations will be available by May 13, 2011.

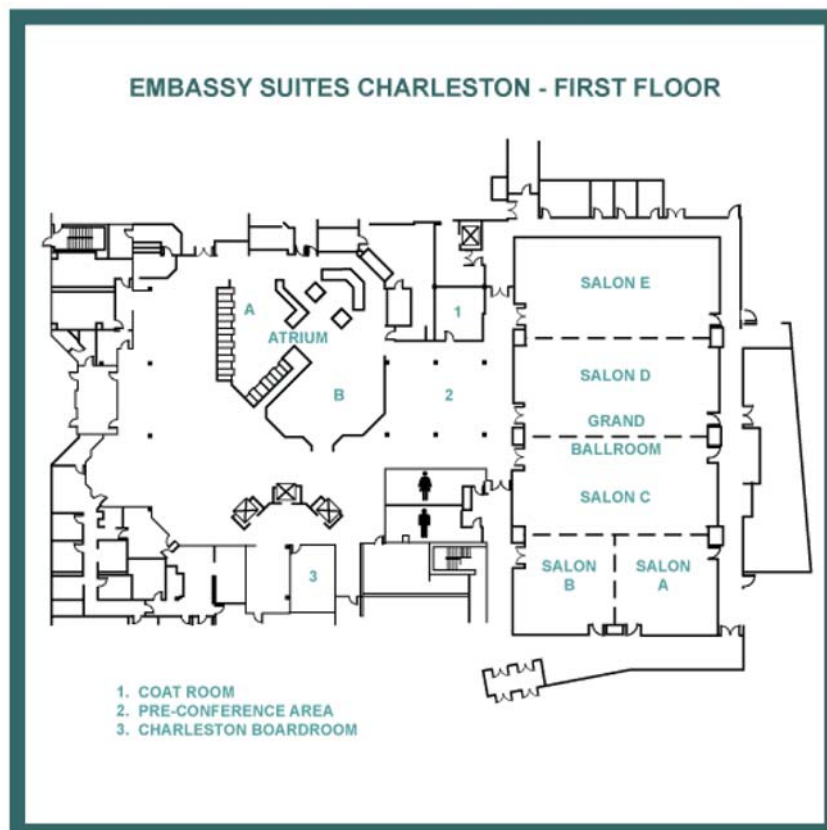



# Schedule-at-a-Glance

## Sunday, May 1

5:00 - 8:00 pm	<b>Registration/Vendor Setup</b> , Pre-Conference Area, Embassy Suites
6:00 - 9:00 pm	<b>Opening Reception</b> , Clay Center for the Arts and Sciences, Sponsored by NADO, DRA, & AASHTO

## Monday, May 2

7:00 am	<b>Registration/Vendor Displays Open/Breakfast*</b>			
8:15 am	<b>Opening Plenary Session</b>			
9:45 am	BREAK, Sponsored by Wilbur Smith Associates			
10:15 am	<b>Session A1</b>	<b>Session A2</b>	<b>Session A3</b>	<b>Session A4</b>
12:00 pm	LUNCH, Sponsored by Economic Development Research Group			
1:00 pm	<b>Session B1</b>	<b>Session B2</b>	<b>Session B3</b>	
2:30 pm	BREAK, Sponsored by Cambridge Systematics			
2:50 pm	<b>Session C1</b>	<b>Session C2</b>	<b>Session C3</b>	
4:30 pm	Adjourn/TREDIS Session			
6:00 pm	Dinner, West Virginia Cultural Center, Sponsored by NADO, DRA, & AASHTO			

## Tuesday, May 3

7:30 am	<b>Registration/Vendor Displays Open/Breakfast*</b>			
8:30 am	<b>"All Star" Plenary Session</b>			
10:00 am	BREAK			
10:20 am	<b>Session D1</b>	<b>Session D2</b>	<b>Session D3</b>	<b>Toyota Plant Tour</b> (leaves at 10:10)
12:00 pm	LUNCH, Sponsored by the Louis Berger Group, Inc.			
1:00 pm	<b>Session E1</b>	<b>Session E2</b>	<b>Session E3</b>	
2:30 pm	BREAK			
2:50 pm	<b>Closing Plenary Session</b>			
4:30 pm	Adjourn			

\*For those individuals staying at the Embassy Suites, a full cooked-to-order breakfast is included in your sleeping room reservation (i.e., there is no additional cost). For those attendees not staying at the hotel, please check with the registration desk as we will have a limited number of breakfast tickets available. Take advantage of this great perk and start your morning off right!

# Sunday, May 1st

5:00 - 8:00 pm **Registration/Vendor Setup**, *Pre-Conference Area, Embassy Suites Charleston*

6:00 -9:00 pm **Opening Reception\***, *Juliet Museum of Art, The Clay Center for the Arts and Sciences of West Virginia*, Sponsored by the National Association of Development Organizations (NADO), Delta Regional Authority (DRA), and the American Association of State Highway and Transportation Officials (AASHTO)

Join us in the Juliet Museum of Art at The Clay Center for the Arts and Sciences of West Virginia for our opening reception. Take a short ½ mile walk from the



Embassy Suites or catch a ride on the shuttle to the Clay Center. Enjoy music by a string trio from the West Virginia Symphony Orchestra, hors d'oeuvres, and a no-host bar as you network and mingle with your colleagues and friends amid the large collection of American art.

Opened on July 12, 2003, the Clay Center houses performing arts, visual arts, and sciences under one roof. It is home to both the Avampato Discovery Museum and the West Virginia Symphony Orchestra. The Avampato Discovery

Museum's permanent collection of art consists of more than 800 pieces of unique and distinguished artworks.

In addition to the museum's permanent collection, a special traveling exhibit will be available for our viewing. NASA|ART: 50 Years of Exploration, organized by the Smithsonian Institution, includes drawings, photographs, sculpture and other media. The traveling exhibition contains 74 works and almost a half-century of creations by artists as diverse as Kahn and Selesnick, Annie Leibovitz, Norman Rockwell, Andy Warhol, Nam June Paik and William Wegman. This collection offers unparalleled insight into the private and personal moments, triumphant victories and tragic accidents that form the storied history of NASA.

\*If you have signed up for this event in advance, your nametag will be ready for you at the Clay Center. If desired you may also pickup your packet at the Registration Desk found in the Pre-Conference Area at the Embassy Suites prior to the Reception. If you have NOT signed up for this event and still wish to attend, please stop by the Registration Desk at the Embassy Suites to inquire about space, register (if there are openings), and pickup your nametag.



# Monday, May 2nd

## A g e n d a

7:00 am **Registration/Vendor Displays Open/Breakfast\***, *Pre-Conference Area, Embassy Suites Charleston*

8:15 am **OPENING PLENARY SESSION**, *Salon D*

### **Welcome and Introductions**

- Robert Plymale, Nick J. Rahall II Appalachian Transportation Institute
- Earl Gohl, Appalachian Regional Commission

### **Remarks**

- Honorable Nick J. Rahall II, US House of Representatives
- Honorable Jay Rockefeller, US Senate
- Honorable Shelley Moore Capito, US House of Representatives

### **Keynote**

- Honorable Ray LaHood, US Secretary of Transportation

### **Closing Remarks**

- Kathy Ruffalo, Ruffalo and Associates, LLC

Distinguished representatives from the West Virginia congressional delegation and the Rahall Appalachian Transportation Institute will welcome attendees to the conference. US Secretary of Transportation, Ray LaHood, will provide the session keynote. Lastly, Kathy Ruffalo from Ruffalo and Associates, LLC will set the context for the conference by discussing federal transportation funding policy at this critical juncture in time. Currently there is no adopted federal reauthorizing legislation in place that sets the direction for the development of our transportation system. The development of which is extremely important to our regional, state, and national economies.

9:45 am **BREAK**, *Pre-Conference Area, Sponsored by Wilbur Smith Associates*

\*For those individuals staying at the Embassy Suites, a full cooked-to-order breakfast is included in your sleeping room reservation (i.e., there is no additional cost). For those attendees not staying at the hotel, please check with the registration desk as we will have a limited number of breakfast tickets available. Take advantage of this great perk and start your morning off right!

# Monday, May 2nd



10:15 am

## CONCURRENT SESSIONS A

The technical portion of the conference will begin with four sessions that explore national and international perspectives on freight and rail issues, a cross-country comparison of the impact of transport on economic activity and an examination of the need for transportation infrastructure improvements caused by cluster-based economic development. A discussion moderated by the National Association of Development Organizations will explore the issues surrounding the critical importance of the role the transportation system plays in supporting new economic development strategies. The Institute for Trade and Transportation Studies will also participate in this moderated session. Lastly, the Appalachian Regional Commission will provide a summary and discussion of the Appalachian Development Highway System.

### **Session A1: National, Regional and Local Studies of Freight Transportation on Economic Performance, Salon D**

Moderator: Jon Skolnik, Jack Faucett Associates, Inc.

Dr. Donetella Cavagnoli, Vicroads, Australia  
*Australia's Freight Reform Initiative*

Brian Alstadt, EDR Group, USA  
*Beyond the Value of Travel Time: Examining the Effects of Shipper Logistics Cost Savings on Economic Investment Decisions Involving Freight Systems*

Joshua Odelye, School of Transport, Nigeria  
*Rail Accessibility Factor in Nigeria Economic Growth Pattern*

### **Session A2: International and Cross Country Comparisons of Transportation and Economic Development, Salon B**

Moderator: Audrey Moruza, Virginia Department of Transportation

Mohammad Aldagheiri, Qassim University, Saudi Arabia  
*The Impact of Road Network Expansion on Agricultural Development: A Review Study of Al-Qassim Region in Saudi Arabia*

Arlee Reno, Cambridge Systematics, USA  
*International Comparisons of the Relationships of Measures of National Transportation Systems to National Economic, Social and Environmental Indicators*

Muhammad Chaundry, Molde University College, Norway  
*Transport Infrastructure and Economic Efficiency - A Cross Country Comparison Using Data Envelopment Analysis*

Eric Cook, Louis Berger Group, USA  
*Can Road Construction Play a Strategic Role in Post-Conflict Recovery and Foreign Assistance Efforts? An Economic Impact Analysis of the Keshim-Faizabad Road in Afghanistan*



# Monday, May 2nd

## A g e n d a

10:15 am

**Session A3: Analysis of Changes in Transportation Infrastructure on Regional and Local Geographies Due to Cluster-Based Economic Development, Salon E**

Moderator: Peggy Tadej, Northern Virginia Regional Commission

Bruce Lambert, Institute for Trade & Transportation Studies, New Orleans Board of Trade, USA

*The Southern Automotive Corridor: Assessing the Contribution on Regional Economic Activities*

Lyle Wray, Capital Region Council of Governments, USA

*Innovation Transit Oriented Development*

Scott Turnoy, Mid-Columbia Economic Development District (MCEDD) in The Dalles, Oregon, USA

*Connecting Clusters and Communities: Transportation Options in the Columbia River Gorge*

**Session A4: The Appalachian Development Highway System (ADHS) - Access to Opportunities, Salon A**

Moderator: Ken Wester, Appalachian Regional Commission

Greg Bischak, Co-Chair, Transportation and Economic Development Committee, TRB  
Dan Hodge, HDR Decision Economics, USA

*Economic Benefits of the Appalachian Development Highway System: A Look Back and a Look Forward*

Beth Jones, Southeast Tennessee Development District, USA

*Assessing Economic Development Need for an Appalachian Development Highway System Corridor*

Lloyd Thompson, Moffatt & Nichol, Inc., USA

*Network Appalachia: Developing an International Reach to Compete in a Global Economy*

12:00 pm

**LUNCH** (provided), Salon C, Sponsored by Economic Development Research Group

**Luncheon Speaker:** Barry Johnson, Senior Advisor and Director of Strategic Initiatives, US Economic Development Administration, US Department of Commerce (introduced by Stephen Fitzroy, Economic Development Research Group)

# Monday, May 2nd



1:00 pm

## **Concurrent Sessions B**

As in any industry, advances in technology need to be explored to improve efficiencies. The sessions will explore such advances on three levels; improved modeling techniques, integration of fiber optic system transportation infrastructure and the development of entirely new transportation systems, such as high speed rail, that can provide options to support economic growth. A concurrent session will focus on the interaction of changes in our climate and transportation and economic development dynamics. These dynamics must be better understood by policy makers. The last session in this grouping will focus on methods to estimate green house gas emissions and the development of the biofuels industry.

### **Session B1: National, Regional and Local Economic Effects of Various Modes of Transportation Infrastructure on Economic Performance, Salon D**

Moderator: Jon Skolnik, Jack Faucett Associates, Inc.

Karen White, Federal Highway Administration, USA

*Scan of Models to Measure Economic Impacts of Transportation*

Martin Weiss, Consultant, USA

*Undiscovered Components in Transportation and Economic Analysis*

Junwook Chi, Nick J. Rahall Appalachian Transportation Institute and Center for Business and Economic Research, USA

*Regional Impacts of a US-35 Toll Road in West Virginia*

### **Session B2: Impacts of Technological Change on Transportation and Economic Development, Salon E**

Moderator: Arno Hart, RNO Group

Stephen Fitzroy, EDR Group, USA

*Economic Development and High-Speed Rail: How Market Access and City Size Influence Development Opportunities*

Melissa Paciulli, University of Massachusetts, USA

*Evaluating Policies for the Expansion of Fiber Optic Infrastructure, Implications for Planning Economic Growth and Integration in Western Massachusetts*

Julie Lorenz, Burns & McDonnell Engineering, USA

*The New Imperative: Collaboration Tools Link Transportation and Economic Development Planning*



# Monday, May 2nd

## A g e n d a

1:00 pm

**Session B3: Energy/Climate Change Policy-Induced Effects on Transportation Investments and Economic Development, Salon B**

Moderator: Greg Bischak, US Department of Treasury

Judith Mwakalonge, Prairie View A&M University, USA

*A Comparison Analysis of Methods Used to Estimate GHG Emissions to Better Understand the Effects of Transportation Investments*

Bruce Lambert, Institute for Trade & Transportation Studies, New Orleans Board of Trade, USA

*The Biofuel Industry in the Southeast - The Implications on Transportation Systems*

Charles Kooshian, Center for Clean Air Policy, USA

*Growing Wealthier: Smart Growth, Climate Change and Prosperity*

2:30 pm

**BREAK, Pre-Conference Area, Sponsored by Cambridge Systematics**

2:50 pm

**Concurrent Sessions C**

It is generally agreed that public transport contributes to economic growth. These may be found in the various economic dynamics in public transport both internal to the provision of service and external to the change in economic values of adjacent land uses being served by the service. The first of the three sessions in this grouping will explore these issues. Many also agree that this dynamic should be examined as part of the process of planning transport systems. This would involve including economic development considerations as part of the formal planning process carried out by regional and state planning and transportation agencies. This will be covered in the second session. Lastly, spatial impacts of transport investments are a critical consideration when assessing the need for improvements and will be covered in this concurrent session.

**Session C1: Economic Growth Impacts of Public Transport Investments, Salon B**

Moderator: Chris Mann, Co-Chair, Transportation and Economic Development Committee, TRB, USA

Pierre Vilain, HDR, USA

*Measuring the Impact of Accessibility Change on Commercial Property Values: The Case of the New Jersey Transit's Midtown District*

Robena Reid, Federal Transit Administration, USA

*Transit Planning in Regional Economic Development Analysis*

Jean-Claude Ziv, Conservatoire National des Arts et Metiers, France

*The "Versement Transport" as a Successful Way to Fund and Develop Public Transport*

# Monday, May 2nd

2:50 pm

## **Session C2: Integration of Economic Impact Analysis into State and Regional Transportation Planning Processes, Salon D**

Moderator: Peter Ogonowski, Wilbur Smith Associates, USA

Glen Weisbrod and Lisa Petraglia, EDR Group, USA  
*Long-term Economic Requirements in Transportation Planning*

Judy Perkins, Prairie View A&M University, USA  
presented by Judith Mwakalonge, Prairie View A&M University, USA  
*Review of State and Regional Practices in Integrating Economic Impact Analysis into the Transportation Planning Process*

Miguel Gaston Cedillo-Campos, COMIMSA, Mexico  
*Uncertainty on Crossing Times at US/Mexican Border: Impacts on Safety Stocks of NAFTA Supply Chains*

## **Session C3: Methodological Innovations in Measuring the Spatial Impact and Distributional Costs and Benefits of Transportation Infrastructure Investments, Salon E**

Moderator: Diana Long, Nick J. Rahall Appalachian Transportation Institute

Brian Gardner Mogensen, Grontmig | Carl Bro, Denmark  
*Calculation of Dynamic Effects in the Socio-Economic Method of Construction Projects in Transport Sector in Denmark*

Sharada Vadali, TTI, USA  
*Spatial Representation in Economic Impact Models*

Dean Hatfield, The Louis Berger Group, USA  
*The Designer's Perspective on Economic Development and Transportation: A Comparison of Project's with Different Demographics and Opportunities*

4:30 pm

**ADJOURN** - Main conference adjourns for the day. Interested individuals are invited to attend the 4:30 pm session sponsored by TREDIS

4:30 pm

## **Challenges Facing the Use of Economic Impact Models by Transportation Agencies - An Open Discussion, Salon E**

Discussion Moderators: Glen Weisbrod, TREDIS Software and Julie Lorenze, Burns & McDonnell Engineering

A practical challenge for transportation agency staff and consultants is communicating economic impact concepts to the public and to decision-makers. Use of sophisticated economic models can help inform discussions and decisions, but only if there is effective translation of key model concepts and analysis results into the language and perspectives of the interested parties to address their needs. This session continues a discussion of the topic that was started at the TREDIS Users meeting at TRB in January. However, it is open to all, as the topic should be of relevance to all researchers and practitioners and is not unique to any single model.

# Monday, May 2nd

6:00 pm

**Dinner**, *West Virginia Cultural Center*, Sponsored by the National Association of Development Organizations (NADO), Delta Regional Authority (DRA), and the American Association of State Highway and Transportation Officials (AASHTO)

## Remarks

West Virginia Governor Earl Ray Tomblin

Begin the evening dining in the Great Hall at the West Virginia Cultural Center. Then get to know “wild and wonderful West Virginia” as you venture into the West Virginia State Museum where you will learn about the rich history, natural resources, and bright future of the Mountain State. Home of the dressed fleas, Daniel Boone’s rifle, and thousands more treasures of West Virginia’s history, The West Virginia Museum showcases West Virginia’s artistic, cultural and historic heritage.

Recently re-opened after a complete renovation, the Collection and Exhibition Units of the West Virginia State Museum collect, preserve, present, promote and document the State of West Virginia in every aspect of its history, culture, art, paleontology, archaeology, and geology from all geographic regions, and socioeconomic backgrounds representing the people, land and industries. The exhibitions are displayed in 26 Discovery Rooms that feature artifacts, works of art, stories, music, film clips and follow a chronological pattern beginning with prehistory and concluding in the 21st century.

Buses will begin loading from the first floor main doors at 5:45 pm. Note: You must have signed up in advance for the dinner. If you are unsure if you have a seat, please check with the conference staff at the Registration Desk.

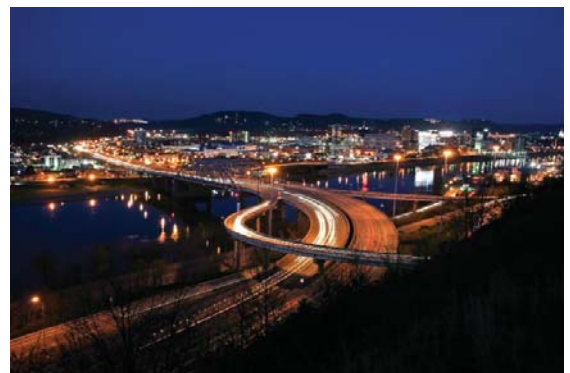

# Tuesday, May 3rd

7:00 am

**Registration/Vendor Displays Open/Breakfast\***, *Pre-Conference Area*

8:30 am

**Morning “All Star” Plenary Session**, *Salon D*

The second day of the conference begins with a thought provoking discussion by three key leaders in transportation-economic development policy formulation.

Moderator: Matt Chase, National Association of Development Organizations

## **Keynotes**

- Chris Masingill, Delta Regional Authority, USA
- Earl Gohl, Appalachian Regional Commission, USA
- Clifford Winston, Brookings Institution, USA

10:00 am

**BREAK**, *Pre-Conference Area*

10:20 am

**Concurrent Sessions D and Tour**

Transportation infrastructure investments have many elements that are critical to their success, some of which involve non-traditional partnerships in their development and delivery. Three presentations will examine three very different elements of transport system development that involve public-private partnerships in project financing, use of public rights-of-way for economic development, and use of public rights-of-way for port development. As an option to complex economic analysis, the case study approach to economic impact measurement has been beneficial to policy makers and analysts in conducting analyses of proposed investments. Results from the SHRP2-CO3 program will be presented with an eye towards providing an additional tool for analysts. Benefit cost analysis and economic impact analysis have been traditional methods for appraising economic impacts. However, they are not uniformly applied across organizations. Presentations will examine various issues in their application with future directions suggested.

**Session D1: Public-Private Sector Roles and Relationships in Promoting Transportation Infrastructure Investments for Economic Development Objectives**, *Salon E*

Moderator: Marwan Madi, Booz Allen Hamilton, USA

Billy Leung, Regional Economic Models, Inc., USA

*The Role of Public Transportation Infrastructure Investment in Private Sustainable Development*

Liat Bonneville, Wisconsin Department of Transportation, USA

*Economic Impacts of Wisconsin’s Commercial Ports, Helping to Keep the State’s Economy Afloat*

M. Kishore Kumar, Border Roads Organisation, India

*Sound Financial Management & Reliable Sources of Funding - Key Attributes for Timely Completion of Highway Projects*



# Tuesday, May 3rd

10:20 am

## **Session D2: Highway Impacts on Economic Development: The SHRP2 - CO3 Program, Salon D**

Moderator: David Plazak, SHRP2 Staff, TRB

David Plazak, SHRP2, TRB, USA

*The SHRP2 Research Program on Transportation, Economic Development and Land Use*

Stephen Fitzroy, EDR Group, USA

*The TPICS Web Tool: a Dataset of Transportation Project Impact Case Studies*

Steven Landau, EDR Group, USA and Rimon Rafiah, Consultant, Israel

*Meta Analysis of Economic Impact Studies: Implications for Highway Investment Planning*

Susan Jones Moses, Susan Jones Moses and Associates, USA

*Conducting Local Case Studies of Highways and their Economic Development Impact*

Paula Dowell, Cambridge Systematics, USA

*Discussion of Measurement Issues*

## **Session D3: Innovations in Transportation Project Economic Development Appraisal, Salon B**

Moderator: Stefan Natzke, National Systems and Economic Development, FHWA

Brian Alstadt, EDR Group, USA

*Emerging Perspectives in Transportation Economic Development and Project Appraisal*

Dan Hodge, HDR Decision Economics, USA

*A Tale of Two Closures: Economic Impacts of Highway Closures in St. Louis and Appalachia*

Eric McClellan, Wilbur Smith Associates, USA

*Benefit-Cost Analysis of Strategic Provincial Roads in Southern and Eastern Afghanistan*

## **Toyota Plant Tour**

Toyota Motor Manufacturing West Virginia (TMMWV) manufactures 4-cylinder and V6 engines for their operations in Indiana and Canada. The West Virginia plant also produces automatic transmissions and gears for plants in Kentucky, Indiana, and Canada. TMMWV was established in 1996 and currently employs 1,006 people. Take a trolley tour through the transmission plant and listen to a presentation on the start-up of the plant and the product line. Tour attendees must be ready to depart at 10:10 am and will return no later than 1:00 pm (sack lunches will be provided). Please meet at the Registration Desk in the Pre-Conference Area.

# Tuesday, May 3rd



12:00 pm

**LUNCH** (provided) *Salon C*, Sponsored by The Louis Berger Group, Inc.

**Luncheon Speaker:** Jose Viegas, Civil Engineering & Architecture Department of the Instituto Superior Técnico, Tech. University of Lisbon (introduced by Greg Bischak, US Department of Treasury)

1:00 pm

## **Concurrent Sessions E**

The final concurrent session will focus on a wide range of topics ranging from equity impacts to the economic impacts of airport investments. Presenters will cover macro-level topics including impacts of transport investments on productivity while other sessions will describe progress on a current NCHRP research project dealing with factors that can influence the siting of freight facilities. Finally, the contribution of investments in aviation facilities on economic performance will be presented.

### **Session E1: Equity and Distributional Considerations for Users and Non-Users of Economic-Induced Transportation Investments, *Salon B***

Moderator: Martin Weiss, Consultant, USA

Dr. Donetella Cavagnoli, Vicroads, Australia

*Commuters' Time on the Road: Is There a Case of Monopoly Pricing?*

Saksith Chalermpong, Chulalongkorn University, Thailand

*Differences in High-Density Residential Development Rate Along Bangkok's Rail Transit Corridors*

Eirini Kastrouni, Iowa State University, USA

*Causal Linkages Between Public Capital, Private Capital and Economic Growth*

### **Session E2: Issues in Intermodal and Multi-Modal Transportation Investment Strategies, *Salon D***

Moderator: Marwan Madi, Booz Allen Hamilton, USA

Dan Hodge, HDR Decision Economics, USA and Chris Steele, CWS Group, USA  
*Economic and Transportation Drivers for Siting Freight Intermodal and Warehouse Distribution Facilities*

Glen Weisbrod, EDR Group, USA

*Advances in Modeling Economic Development Impacts of Multi-Modal Investments*

Jason Bittner, National Center for Freight & Infrastructure Research and Education, USA

*Improving Container Availability and Intermodal Activity in the Heartland*



# Tuesday, May 3rd

## A g e n d a

1:00 pm

**Session E3: National, Regional and Local Studies of Air Transport on Economic Performance, Salon E**

Moderator: Jim Gillespie, Virginia Center for Transportation Innovation and Research

Richard Klophaus, Worms University of Applied Sciences, Germany  
*Economic Benefits of Night Flights: The Case of Germany*

Steven Landau, EDR Group, USA  
*Economic Impacts of Complimentary Roadway and Airport Expansions*

Apiwat Ratanawarah, Chulalongkom University, Thailand  
*Infrastructure-Induced Rent and Rent Seeking: A Case Study of Bangkok's Airport*

2:30 pm

**BREAK, Pre-Conference Area**

2:50 pm

**Closing Plenary Session, Salon D**

Speakers will close the conference with presentations on their views of the accomplishments of the conference with suggestions for the future direction of research in transportation and economic development. Attendees are encouraged to give their views and suggestions on new research.

Moderator: Chris Mann, Co-Chair, Transportation and Economic Development Committee, TRB, USA

**Keynotes**

- Glen Weisbrod, EDR Group, USA
- Jean-Claude Ziv, Conservatoire National des Arts et Metiers, France
- Greg Bischak, Co-Chair, Transportation and Economic Development Committee, TRB, USA

4:30 pm

**ADJOURN**

## **Aldagheiri, Mohammad**

Qassim University, Saudi Arabia  
Presenting in Session A2

I am assistant professor of economic geography - Geography Department - Faculty of Arabic Language & Social Studies - Qassim University in Saudi Arabia. My interested area is economic geography especially about transportation geography and its relationship with economic development. I previously served as a head of Geography Department in Qassim University and now I am vice dean of graduate studies for development and quality in Qassim University. I am a member in some administrative councils such as; administrative council of Saudi Geographical Society and administrative council of Social Development Center in Buraydah. I participated in the Establishing of Geographical Information Systems Laboratory in Geography Department and I established the Photogrammetry Laboratory in Geography Department- Faculty of Arabic Language & Social Studies in Qassim University.

I received my undergraduate degree in Geography from Al-Imam Mohammad Ibn Saud University in 1999 - Saudi Arabia, my Master of Science degree in geography from University of Leicester in 2004 and the Doctor of Philosophy degree in geography from University of Leicester in 2008 - United Kingdom. I have several scientific researches in some research areas such as; economic geography, transportation and transport network, economic resources, minerals industry and sustainable development.

## **Alstadt, Brian**

EDR Group, USA  
Presenting in Session A1 and Session D3

Brian Alstadt is an economic consultant at Economic Development Research Group. His work centers on topics in economic geography, including economic impacts of transportation investment, transportation finance, regional development, trade, and policy analysis.

Prior to joining EDR Group, Mr. Alstadt worked at the Connecticut Center for Economic Analysis (CCEA) in Storrs, CT as a research assistant. At CCEA, Brian performed policy analysis and economic forecasting for public and private clients, and projects ranged from characterizing health care policies to assessing the viability of land value taxation. Brian holds two Master's degrees from the University of Connecticut – one in Economics and the other in Transportation Engineering.

His presentations range from the Annual Conference of the Transportation Research Board (topic: economic development returns from transportation investment) to the International Human Dimensions Programme on Global Environmental Change (topic: interactions between transportation and land use) and the OECD Roundtable on Transportation Planning and Economic Assessment Tools.

## **Bischak, Greg**

Chair, Transportation and Economic Development Committee TRB, USA  
Presenting in Session A4 and Closing Session, Moderating in Session B3



Greg Bischak is the Program Manager of Financial Strategies and Research for the Community Development Financial Institutions Fund (CDFI) at the US Department of Treasury where he manages the Fund's research and analysis efforts, develops the agency's performance data and analysis, performs liaison work with other federal agencies and industry groups; prepares testimony to respond to congressional committees questions about the attainment of Fund's goals, and develops long-range strategic research to ensure effective implementation of Fund's mission.

Dr. Bischak received his doctorate from the New School for Social Research in New York City in 1988, and has taught as an assistant professor of economics. He is a member of the Transportation Research Board of the National Acad-



# Bi - Bo

emy of Science, and serves on the Transportation and Development Committee. His areas of expertise are regional economics, input-output analysis, industrial organization and transportation and energy economics. Prior to coming to CDFI, Dr. Bischak was the senior economist for the Appalachian Regional Commission from 1996 to 2008, where he conducted and directed research on the various aspects of the economic development needs and programs of the thirteen-state Appalachian Region. From 1990 to 1996 he was the executive director of the National Commission for Economic Conversion and Disarmament, where he was responsible for administering the organization and developing public education and policy research on topics of economic conversion, defense employment impacts, disarmament and industrial policy.

His research has been published in a wide variety of scholarly journals and publications.

## **Bittner, Jason**

National Center for Freight & Infrastructure Research and Education, USA  
Presenting in Session E2

Jason Bittner is the Deputy Director and a Research Scientist with the National Center for Freight and Infrastructure Research and Education (CFIRE) at the University of Wisconsin-Madison. He is a primary staff member for the Mid-America Freight Coalition, a collaborative effort of the ten state DOTs in the AASHTO Midwest region. He has completed research projects ranging from an analysis of the Panama Canal Expansion on Midwest Grain exports to a look at Performance Impact of Freight Projects. He has published several peer reviewed articles and authored numerous conference and seminar presentations related to freight transportation and infrastructure asset management.

Jason is a member of the TRB Committee on Transportation Asset Management and co-chair of the Committee on Conduct of Research. He was a principal developer of the Maintenance Quality Assurance Resource Library hosted by the University of Wisconsin. He holds a Master's Degree from the La Follette School of Public Affairs at the University of Wisconsin and his Bachelor's from the American University in Washington, D.C. Jason is a lecturer in Transportation Management and Policy at UW-Madison and was an Adjunct Professor of Political Science at Edgewood College.

He is a member of the executive committee for the American Society for Public Administration, Section on Transportation Policy Analysis. He is actively involved in education and outreach activities related to transportation policy and was a Eno Leadership Development Conference Fellow. Previous to his work at the University of Wisconsin, Jason was an Assistant to the Municipal Manager in New Lebanon, Ohio, responsible for public works, economic development, and council relations.

## **Bonneville, Liat**

Wisconsin Department of Transportation, USA  
Presenting in Session D1

Liat Lichtman-Bonneville is an Urban & Regional Planner in Wisconsin Department of Transportation's Bureau of Planning and Economic Development, where she conducts economic research and analysis for WisDOT's long-range multimodal transportation plans.

Liat has coauthored several research studies that were sponsored by the Federal Highway Administration and the Council on Research, including a report she presented at an annual Transportation Research Board Conference. Tools used in these studies include socioeconomic data analysis, GIS, interviews and surveys, traffic forecasting, and economic impact modeling.

Liat began her career with WisDOT in 1993 as a policy manual editor. She holds a BA in Economics, International Relations, and French from the University of Wisconsin-Madison.

## Capito, Shelley

US House of Representatives, USA  
Presenting in the Opening Session



Rep. Shelley Moore Capito represents the people of West Virginia's Second Congressional District in the 112th Congress, where she has been an advocate for a range of policies that directly impact her constituents, including energy independence, quality healthcare and the safety and security of our service men and women. She prides herself on being approachable and accessible to her constituents. She is currently the only woman in West Virginia's congressional delegation.

Capito serves on the House Financial Services Committee as Chairman of the Subcommittee on Financial Institutions and Consumer Credit. She also sits on the House Committee on Transportation and Infrastructure - the panel which will direct important highway legislation during the 112th Congress.

The Congresswoman has proudly served West Virginia for more than 12 years.

## Cavagnoli, Donetella, PhD

Vicroads, Australia  
Presenting in SSession A1 and Session E1

PhD Economics – Ba Economics (Honors) Donatella has recently completed her PhD in Economics at La Trobe University (Melbourne – Australia). She has seven years experience working in economics, policy and strategy. Her expertise in the economic evaluation of supply elasticities is applied to investigate the responses of individuals and firms to price and non-price changes. Donatella has been working with the Victorian Department of Transport, the ARRB group, the Economics Department at the University of Melbourne and Vic Roads, to contribute to transport planning initiatives and pricing reforms. Interests: Labour Economics, Transport Economics and The Economics of Innovation

## Cedillo-Campos, Miguel Gaston

COMIMSA, Mexico  
Presenting in Session C2

Miguel Gaston Cedillo-Campos is a Professor of Supply Chain Management at COMIMSA (National Council of Science & Technology) and former Founding Director of the Supply Chain Research and Development Center at Tecnológico de Monterrey (ITESM). He is also an Associate Professor at the Logistics & Supply Chain Management Master's Program at the University of Nuevo Leon (Monterrey). Recently he was collaborating as Visiting Researcher at MIT-Zaragoza Logistics Center. Currently, he collaborates with the Mexican Office of Texas Transportation Institute. Dr. Cedillo-Campos is a National Researcher Level 1 at the National Council of Science & Technology (CONACYT-Mexico).

Dr. Cedillo-Campos obtained a M.Sc. degree in Transportation Systems from the National University of Mexico (UNAM) and a M.Sc. degree in Logistics and Organization from Logistics and Transportation Research Center (CRET-LOG), Aix-en-Provence, France. In 2004, he received a Ph.D. degree in Logistics Systems Dynamics from the University of Paris. He has worked for logistics businesses in Mexico and as a consultant for companies like DAIMLER-CHRYSLER, CATERPILLAR, MABE, WTC Confianza, IBM, Met-Mex PEÑOLES, and several Mexican State Governments. Dr. Cedillo-Campos' research work has been published in several leading academic journals and international conferences. He is co-author of book "Dynamic Analysis of Industrial Systems" published by Editorial Trillas, and member of Editorial Review Board of several recognized international journals. His current research projects have received research grants from the Mexican and global firms, as well as from the National Council of Science and Technology of Mexico.



# Ch - Co

## **Chalermpong, Saksith**

Chulalongkorn University, Thailand  
Presenting in Session E1

Saksith Chalermpong is Assistant Professor at the Department of Civil Engineering, Chulalongkorn University. He received a bachelor's degree in civil engineering from Chulalongkorn University, a master's degree in transportation from MIT, and a doctorate in transportation from UC Irvine. His primary research areas include transportation economics, interrelationship between transportation and land use, and transportation policy. He has published a number of research papers and served as referee for several leading transportation journals. He has also served on advisory boards for major government agencies in Thailand, such as the State Railways of Thailand and the Department of Land Transport.

## **Chaundry, Muhammad**

Molde University College, Norway  
Presenting in Session A2

Muhammad Omer Chaudhry (31) is a doctorate student in Logistics and Transport Economics at Molde University College, Molde, Norway. He has a masters in Logistics (2006) from Molde University College, Norway, M. Phil in Economics (2004) from Bahauddin Zakariya University, Pakistan and masters in Economics (2000) from Government College, Lahore, Pakistan. His Ph. D research deals with the relationship of transport infrastructure and economic development. Chaudhry is also serving as Lecturer in Economics (on study leave) at Bahauddin Zakariya University, Multan, Pakistan.

## **Chi, Junwook**

Nick J. Rahall Appalachian Transportation Institute and Center for Business and Economic Research, USA  
Presenting in Session B1

Dr. Chi received his Ph.D. in Transportation & Logistics at North Dakota State University (NDSU) and his dissertation was an econometric analysis of demand for air-passenger service and carrier's pricing strategies. His research interests include strategic freight analysis, truck regulation, tolling, intermodal transportation, demand forecast, regional economic impacts, pricing behavior, and price discrimination models. Rural transportation issues related to rail, inland waterways, highways, and air are focused and he has numerous journal papers and technical reports. Dr. Chi manages and conducts various research projects for the U.S. Army Corps of Engineers on commodity flow on inland waterways. He also conducts various projects for the West Virginia Department of Transportation (e.g., toll traffic and revenue study, high speed intercity passenger rail plan, multi-modal transportation and King Coal Highway projects, etc.).

## **Cook, Eric**

The Louis Berger Group, USA  
Presenting in Session A2

Eric Dean Cook is a Senior Engineer for The Louis Berger Group's Nation Building infrastructure services group in Washington, D.C. His core responsibility in the group is providing program management and technical engineering support for international transportation infrastructure projects. He is a registered professional civil engineer with 20 years experience in transportation engineering and construction management. Since 2004, he has supported the group's USAID Afghanistan reconstruction programs in various roles such as a Transport Sector Team Leader, Transport Sector Support Lead, Deputy Project Manager and Program Quality Assurance Manager. Previous experience includes serving as a Project Engineer with the WV Department of Transportation, General Manager for a heavy construction company, and several years of military service as a U.S. Army commissioned officer. Mr. Cook is a graduate of the U.S. Army's Officer Candidate School, Engineer Officer Basic Course, Civil Affairs Officer Advance Course, Airborne School, Special Forces Qualification Course, S.E.R.E., Basic Military Language Course (French), and has served with distinction on several overseas deployments as an U.S. Army Special Forces A-Detachment Commander and Operations Officer. He holds a B.S. in Civil Engineering from Virginia Tech, an M.B.A from Manchester Business School, and a Masters in Finance from Indiana University.

## **Dharan, Anjali**

Economist, The Louis Berger Group, USA  
Presenting in Session A2

Anjali Dharan is an Economist for The Louis Berger Group's Technical Services group in Washington D.C. She has 5 years combined international work experience with analytical and management skills in the fields of economics and policy analysis. She is specialized in randomized controlled trial evaluations and before-after comparison impact evaluations. She also specializes in monitoring and evaluation, econometric analysis, survey instrument design and project management. While at LBG, Ms. Dharan worked in Afghanistan and led the implementation of the post-project socio-economic study and monitoring and evaluation efforts for the Keshim-Faizabad Road reconstruction project under USAID-funded Infrastructure and Rehabilitation Program, a \$1.4 billion five-year program focuses on rehabilitating and extending provincial roads, power generation capacity, and power transmission networks. She helped develop the sampling methods and design of nine different survey instruments to assess impact and economic improvement of local households, businesses, transport companies and vehicle operators. Ms. Dharan received her Master's in International Economics and Development from the Graduate School of International Relations & Pacific Studies (IR/PS) at University of California, San Diego. She has a B.A. in International Relations from Emory University.

## **Dowell, Paula**

Cambridge Systematics (CS), USA  
Presenting in Session D2

Dr. Dowell, a Principal with CS, has more than 15 years of experience in fiscal and economic analysis. She is leading Cambridge Systematics' Economics Practice. Dr. Dowell has focused her career on applying her economic training to real world decision making. She has served as project manager/senior consultant for numerous economic planning studies including the Return on Investment of Transit Investments for the Twin Cities Region; Economic Effects of the Proposed Bay Area Rapid Transit (BART) Extension to San Jose; the development of the Michigan Benefit Estimation System for Transportation (BEST) used for evaluating both programmatic expenditures and project level investments; numerous Regional Freight Studies including for the Atlanta Region and the Houston-Galveston Region; Economic and Fiscal Impacts of the Multimodal Eastern Corridor in Southern Ohio; Florida Strategic Intermodal System Project Prioritization Tool; and the Economic Impact of Transit Investments in Tampa, FL. All of these efforts were for the purpose of quantifying and communicating the economic implications of various transportation investments to elected officials, DOT management and the general public. Dr. Dowell also has extensive experience in managing large-scale, multistate trade and transportation studies including the Northeast CanAm Connections Study, the Continental 1 Corridor study and the Appalachian Region Intermodal Opportunities Study, and the Latin American Trade and Transportation Study.

In addition to her project involvement, Dr. Dowell has extensive research experience and she currently serves as the senior economist on projects for the National Academies including NCFRP 5: Developing a Framework for Estimating the Benefits of Large Scale Freight Projects and NCHRP 8-36: Examining the Effectiveness of Transportation Investment to Stimulate the Economy. In addition, Dr. Dowell serves on several committees for the National Academies Transportation Research Board including Transportation Economics, Transportation and Economic Development and Urban Goods Movement. Previously, she served as a Post Doctorate Research Associate for the Center of Business and Economic Research at the University of Tennessee, Knoxville. She has worked on transportation planning and policy projects in more than 30 of the US states as well as numerous international locations including Europe, Mexico, Canada, India, and Africa.

## **Fitzroy, Stephen**

EDR Group, USA  
Presenting in Session B2 and D2

Stephen S. Fitzroy is Director of Operations Research and Trade Analysis at EDR Group. Dr. Fitzroy's expertise is in analyzing the economic effects of investments in transportation infrastructure, especially with regard to the effects of these investments on regional competitiveness and the effects of transportation system

# Gi - Go

productivity enhancements on key strategic economic sectors of the US and regional economies. His current work includes several regional and statewide transportation studies and research sponsored by the US Transportation Research Board on the economic impacts of transportation infrastructure investments. In addition to his extensive experience in economic analysis, Dr. Fitzroy has been responsible for providing technical and management services in the areas of risk assessment and decision analysis, strategic planning and policy development, economic impact assessment, and a wide variety of market-oriented assessment and economic analyses.

Prior to joining EDR Group, Inc., Dr. Fitzroy was Program Manager for the TRACX On-site Operations Research program at the Volpe National Transportation Systems Center. He has also held positions as Managing Director of ECONorthwest's Seattle office, Principal Economist for The Louis Berger Group's Planning and Economics Department, Business Manager and Principal Economist for Standard & Poor's DRI's (now Global Insight) International Trade and Transportation practice, and Director of Research and Forecasting for the Puget Sound Regional Council. He is a member of the TRB's Congestion Pricing Committee (ABE25) and Environmental Justice Committee (ADD50). He served as the Chair of the Joint Subcommittee on the Economics of Pricing (ABE25(2)) and is a past member of the Transportation Economics Committee (ABE20 – 1999 to 2008)

## **Gillespie, James**

Virginia Center for Transportation Innovation and Research, USA  
Moderating in Session E3

Jim Gillespie received a B.A. in Chemistry from the University of Chicago, and an M.A. in Economics from the University of Virginia. He is a Senior Research Scientist at the Virginia Center for Transportation Innovation and Research (VCTIR). He has done research at VCTIR for over seventeen years, on projects ranging from transportation finance, forecasting, demand modeling, and cost-benefit analysis, to life-cycle cost analysis, equipment management, and innovative contracting. He has authored or co-authored numerous reports and published articles on these topics. Mr. Gillespie is a member of the TRB Committee on Transportation Economics (ABE20), a past secretary of the Committee on Transportation and Economic Development (ADD10), and a past member of the Committee on Public Transit Planning and Development (AP025). He has served on two TCRP project panels and six NCHRP project panels, two of which he chaired. He is also a member of the American Economic Association.

## **Gohl, Earl**

Appalachian Regional Commission, USA  
Presenting in the Opening and "All Star" Plenary Sessions



Earl F. Gohl was unanimously confirmed as federal co-chair of the Appalachian Regional Commission (ARC) by the U.S. Senate on March 10, 2010.

Gohl came to ARC with 20 years of experience in Pennsylvania state and local government. From 1975 to 1995, he held positions including executive assistant to the mayor of Harrisburg; elected member of the Harrisburg City Council; deputy secretary of the Pennsylvania Department of Community Affairs; and director of the Pennsylvania governor's Washington office. As deputy secretary, Gohl awarded and administered \$100 million annually in housing and community development programs benefiting communities within the Appalachian Region. He also managed several initiatives to strengthen the capacity of rural local governments to meet economic challenges. From 1996 to 2001, Gohl served as a special assistant, and then as an associate assistant secretary, at the U.S. Department of Labor. From 2001 to 2009, Gohl was the director of government relations/deputy director for the Puerto Rico Federal Affairs Administration, where he formulated legislative and executive branch initiatives related to taxes, economic security, health care, education, nutrition, environment, homeland security, labor, housing, and transportation. Gohl holds a Bachelor of Arts degree from Rider College (now Rider University) in New Jersey and a master of public administration degree from Pennsylvania State University.

# Ha - Ho



## **Hart, Arno**

RNO Group  
Moderating in Session B2

Arno Hart, Social Media Director at Transport Social Media Studio, Freight and Intermodal Transportation Planning Director at 3GIntermodal, Founder and Owner at RNO Group. He has served as Regional Vice President - Western Transportation Group Operations Manager at Wilbur Smith Associates, Vice President - Economics, Freight & Finance Division at Wilbur Smith Associates, Senior Economist - Freight Transportation and Economic Development at Wilbur Smith Associates, Trade and Transportation Economist at Wilbur Smith Associates Enterprise Development Planner at Gold-Hammer Venture Associate Manager and Economist, Prospect Market Research at South Carolina Department of Commerce. He attended the University of South Carolina - The Moore School of Business

An economist, freight transportation consultant and social media entrepreneur with a successful track record starting and building consulting practices in economics, trade, transportation, personnel recruitment, training, business planning and social media. Managed consulting projects throughout the USA, and in Canada, Latin America, Asia, Europe and Africa. Latest projects include promotion of the 3rd Generation Intermodal initiative ([www.3gintermodal.com](http://www.3gintermodal.com)), a Social Media Studio for the Transportation sector ([www.transportsms.com](http://www.transportsms.com)), and a social media enterprise 2.0 application called Skuzme ([www.skuzme.com](http://www.skuzme.com)).

## **Hatfield, Dean**

The Louis Berger Group, USA  
Presenting in Session C3

Dean Hatfield, a civil engineer with 28 years of transportation engineering experience, works in multi-disciplinary teams to enhance how transportation contributes to healthy, vibrant communities. Mr. Hatfield, a 'hands-on' project manager, has been involved with the planning, design management, and construction administration of a wide variety of transportation projects. His most recent project assignments include Project Manager for the \$26 million transportation infrastructure related to a 1,400 acre development in the Research Triangle Area of North Carolina and Project Manager for the final design plans for a 40 km segment of the Bamyan to Dushi Road Reconstruction in Afghanistan for USAID.

He has served as project design engineer or project manager on facilities including interstate, freeway, arterial, secondary and bridge replacements. These projects have consisted of intersection improvements, widening, freeway conversions, new locations, re-construction, interchange improvements, and multi-level interchange design. His focus is at the intersection of transportation design concept and turn-key delivery with consideration for the long term utilization with environmental commitment. Dean a registered Professional Engineer in North Carolina, South Carolina, Virginia, Nevada, and West Virginia.

## **Hodge, Dan**

HDR Decision Economics, USA  
Presenting in Session A4, Session D3 and Session E2

Dan Hodge, Principal Economist with HDR Decision Economics in Boston, has 16 years of experience in regional economic modeling, freight and trade flow analysis, economic development, benefit/cost analysis, and public finance. Dan works throughout New England and nationally on a variety of economic analysis, transit-oriented development, freight planning, and renewable energy feasibility studies. He recently developed and applied a Sustainable Return on Investment (SROI) model for the City of Boston to evaluate the sustainability benefits of their Federal stimulus-funded investments and was project manager of a major study to evaluate the economic impacts and return on investment of completing the Appalachian Development Highway System.

Dan recently completed the Massachusetts Freight and Rail Plan and is deputy project manager for a National Cooperative Freight Research Project on the economic and transportation factors for siting freight logistics facilities. He was the lead author of a guidebook for the U.S. DOT on the economic impacts of freight

# Ho - Jo

investments and is leading the development analysis and financing strategies for a Providence streetcar project. He holds masters degrees in Economics and Public Policy from the University of Michigan.

## **Hoehner, David**

Economist and Senior Institutional Reform Specialist, The Louis Berger Group, USA  
Co-Presenting in Session A2

David Hoehner is a Senior Institutional Reform Specialist for The Louis Berger Group's Technical Services group in Washington D.C. He has over 10 years of experience in governance reform, policy development, program management, program evaluation, research and writing. While at LBG, he developed the M&E program for the USAID-funded Afghanistan Infrastructure Rehabilitation Program, a \$1.4 billion five-year program devoted to the rehabilitation and development of important physical infrastructure as well as to key institutional reform and capacity building in the transport and energy sectors. As a part of this, he helped develop and implement the research design for socio-economic studies of two provincial roads. Most recently, he has been leading a USAID-sponsored governance reform project to strengthen the sustainability of Afghanistan's newly rehabilitated road network, through helping to establish a Road Authority and Road Fund that use a more commercialized approach to transport management in order to provide more ownership to private sector stakeholders. He earned a B.A. in Liberal Arts from the University of Texas and received an M.A. in International Relations and International Economics from John Hopkins University.

## **Jones, Beth**

Southeast Tennessee Development District, USA  
Presenting in Session A4

Beth Jones is the Executive Director of the Southeast Tennessee Development District/Chattanooga Regional Council of Governments. Beth has been with the agency for 14 years serving in leadership roles for economic and community development programs. Beth is in charge of all agency activities, including the Administration, Planning, Economic Development and Community Development Departments; the Southeast Tennessee Area Office on Aging; the Southeast Industrial Development Agency; and the Workforce Development staff. She has been instrumental in promoting regional development and workforce initiatives throughout the tri-state region of Georgia, North Carolina, and Tennessee. Prior to her role with the Development District, she worked for almost eighteen years as a Regional Field Director for U. S. Senator Jim Sasser and was instrumental in legislative initiatives that resulted in funding to the U. S. Forest Service for the Ocoee Whitewater Center home to a 1996 Olympic Whitewater Venue in Polk County, funding for the NEPA Planning Process to surplus the former Volunteer Army Ammunitions Plant which is now the redeveloped Enterprise South Industrial Park (Home to Volkswagen) and significant funding for the reclamation of abandoned strip mines into green space and recreational parks as well as initial funding for the historic preservation of the Walnut Street Bridge in Chattanooga and for the rehabilitation of substandard housing in economically distressed neighborhoods through the Chattanooga Neighborhood Enterprise Fund.

## **Johnson, Barry**

EDA, US Department of Commerce, USA  
Luncheon Speaker



Barry Johnson serves as Senior Advisor and Director of Strategic Initiatives for the U.S. Economic Development Administration (EDA) within the U.S. Department of Commerce.

With over 15 years of experience as a senior executive forming public/private partnerships, Barry leads EDA's strategic partnership programs, collaborating with the White House, other federal agencies and regional leaders to implement innovative regional solutions to improve competitiveness and foster economic growth throughout the nation.

Prior to this role, he was founder and managing principal at Acresh Develop-

# Ka - Ko



ment, a public-private real estate development and advisory firm, and vice president of the Public Sector Division of the Staubach Company. Barry also has an extensive background in starting innovative new businesses, having led a joint venture between Microsoft and BET. He also created the interactive entertainment division for Sony Music Entertainment's Epic Records Group. Mr. Johnson also started successful new businesses within the Walt Disney Company and BMG Music Group. Leveraging his background in investment banking, Barry also successfully secured venture capital to syndicate web content to niche audiences globally.

Committed to giving back through volunteerism, Barry is an active mentor, motivational speaker on college campuses nationally, and is a volunteer instructor for the Inner City Adult Entrepreneurship program at the Harrison Institute of Georgetown Law.

A native of Birmingham, Alabama, Barry earned a Master's degree in Business Administration from the Harvard Business School after receiving a Bachelor of Arts in Economics and Political Science from Yale College.

## **Kastrouni, Eirini**

Iowa State University, USA  
Presenting in Session E1

Eirini Kastrouni is a Graduate Research Assistant in the Department of Civil, Construction and Environmental Engineering at Iowa State University. She received her Diploma in Civil Engineering from the National Technical University of Athens, Greece in 2010. Her research interests lie in transportation economics, transportation and economic development, transportation energy and sustainability, and travel behavior.

## **Klophaus, Richard**

Worms University of Applied Sciences, Germany  
Presenting in Session E3

Richard Klophaus is Professor of Business Management, Transportation and Logistics at the Worms University of Applied Sciences, Germany. He is also Executive Director of the Centre for Aviation Law and Business serving as a consultant for both government and the aviation industry. Current projects include airport planning studies. His career began at Lufthansa German Airlines in the fields of network management, pricing and revenue management. He holds a PhD in Economics from the University of Mannheim.

## **Kooshian, Charles**

Center for Clean Air Policy, USA  
Presenting in Session B3

Chuck Kooshian, Senior Transportation Policy Analyst at the Center for Clean Air Policy, has more than twenty years experience in transportation and land use planning for regional and local government. At CCAP he evaluates national, state and local transportation policy alternatives and their effects on GHG emissions, governmental planning processes and institutional coordination issues. He is the author of *Growing Wealthier: Smart Growth, Climate Change and Prosperity*. He has developed a framework for comparing alternative legislative proposals for transportation and climate change. He has studied the cost effectiveness of various land use and transportation measures to reduce GHG emissions and studying the data needs for performance evaluation and emissions modeling to support climate change mitigation.

Chuck has experience as a travel demand modeler. He developed travel models for a consulting firm in California and for Metropolitan Planning Organizations in Michigan, Florida and Texas. He has also worked as a long range comprehensive planner in Texas, where he was involved in selection and planning of transportation projects and assessing their effects on land use. Chuck has worked on international air quality issues along the U.S. - Mexico border and formulated recommendations for cooperative actions to reduce pollution in the border region. Chuck holds an MS in Urban and Environmental Systems from Florida International University and a BA in Political Science from the University of California at Berkeley.

# Ku - La

## **Kumar, M. Kishore**

Border Roads Organisation, India  
Presenting in Session D1

Mr. M. Kishore Kumar is a civil engineer by profession and has a master's degree in Building Engineering & Construction Management. As a practicing highway & bridging engineer with Border Roads Organization of Government of India since 1990s, he was engaged in various activities from alignment survey of road, design & estimates of road construction, approvals of Detailed Project Reports along with construction & maintenance of various highways, some of them at altitudes of 12,000 feet above mean sea level (MSL). He is also actively associated with planning, design, construction & maintenance of a variety of bridges on the strategic border roads. Furthermore, he had a tenure as Professor in the Department of Civil Engineering at the prestigious College of Military Engineering, Pune (India) during the years 2000-03. He is currently involved in a research work on time and cost over-runs in highway projects in India. He takes keen interest in disseminating the knowledge gained from his work experience and has authored many technical papers.

## **LaHood, Ray**

US Secretary of Transportation, USA  
Presenting in the Opening Session



Ray LaHood became the 16th Secretary of Transportation on January 23, 2009.

In nominating him, President-elect Obama said, "Few understand our infrastructure challenge better than the outstanding public servant that I'm asking to lead the Department of Transportation."

Secretary LaHood's primary goals in implementing President Obama's priorities for transportation include safety across all modes, restoring economic health and creating jobs, sustainability – shaping the economy of the coming decades by building new transportation infrastructure, and assuring that transportation policies focus on people who use the transportation system and their communities.

As Secretary of Transportation, LaHood leads an agency with more than 55,000 employees and a \$70 billion budget that oversees air, maritime and surface transportation missions.

Secretary LaHood said he would bring President-elect Obama's priorities to the Department and see them effectively implemented with a commitment to fairness across regional and party lines and between people who come to the issues with different perspectives.

Before becoming Secretary of Transportation, LaHood served for 14 years in the U.S. House of Representatives from the 18th District of Illinois (from 1995-2009). During that time he served on the House Transportation and Infrastructure Committee and, after that, on the House Appropriations Committee. Prior to his election to the House, he served as Chief of Staff to U.S. Congressman Robert Michel, whom he succeeded in representing the 18th District, and as District Administrative Assistant to Congressman Thomas Railsback. He also served in the Illinois State Legislature.

Before his career in government, Secretary LaHood was a junior high school teacher, having received his degree from Bradley University in Peoria, Illinois. He was also director of the Rock Island County Youth Services Bureau and Chief planner for the Bi-States Metropolitan Planning Commission in Illinois.

LaHood and his wife, Kathy, have four children (Darin, Amy, Sam, and Sara) and nine grandchildren.

**Lambert, Bruce**

Institute for Trade & Transportation Studies, USA  
Presenting in Session A3 and Session B3

Mr. Lambert serves as the Executive Director, Institute for Trade and Transportation Studies. ITTS is a multi-state research institution formed to assist member states on understanding the relationship of transportation needs to international and commercial traffic.

Mr. Lambert has worked for various firms researching trade and transportation activities. At the Corps of Engineers, Mr. Lambert worked on general maritime policy and planning, while also serving as the Secretary to the U.S. Section of the International Navigation Association (PIANC), and worked on technology exchanges with the Latin American maritime community. Prior to joining the USACE, Mr. Lambert worked at the Federal Highway Administration. Mr. Lambert managed the Freight Analysis Framework study; the first large-scale project to map and outline the underlying transportation flows of the United States economy for national and regional policy research. In addition, Mr. Lambert developed performance measures for trucking movements on the interstate system. For his efforts, Mr. Lambert received the U.S. Department of Transportation's Award of Meritorious Achievement in 2004. Before joining FHWA, Mr. Lambert worked as a Senior Economist at Standard and Poor's DRI (now IHS Global Insight), where he examined global maritime shipments and international trade forecasts. Mr. Lambert spent six years at the Port of Long Beach as the Port's Trade Analyst, conducting market research for senior management. Mr. Lambert also spent a year at LSU as a researcher studying the importation of Latin American produce into the Gulf South.

After receiving a Bachelor's of Science Degree from Louisiana State University, Mr. Lambert earned a Master's of Science Degree from the University of Tennessee.

**Landau, Steven**

EDR Group, USA  
Presenting in Session D2 and Session E3

Mr. Landau has more than twenty years of experience working with federal, state, regional and local transportation and economic development agencies. For nearly 12 years, he directed economic development for the Boston regional Metropolitan Planning Organization (MPO). At the Economic Development Research Group, he has developed on how economic development is leveraged by investments in highways, aviation, rail and transit. Mr. Landau has also developed original case study research on the economic impacts of targeted roadway development for economic growth and the changing roles of highways and airports in domestic and international freight movement, and economic development implications at an industry level. Recent projects range from the economic development implications of the proposed Massachusetts South Coast Commuter Rail to an analysis of goods movement in Ontario and the potential economic development opportunities associated with new air cargo investments in Atlanta. At Boston's MPO, he developed case studies on the roles played by highways in successful implementation of brownfield redevelopment policies, in land-use development along prominent highway corridors and economic and land use changes induced by transit development.

Mr. Landau has served on numerous boards and advisory committees related to economic development. He is currently on the Board of Directors of the Northeastern Economic Developers Association, is a member of the International Economic Development Council, and is a member of the Aviation System Planning Committee (AVO 20) of the Transportation Research Board. He has been a featured speaker at professional conferences and workshops. He holds a BA in US History from the University of Massachusetts and a Masters in City Planning degree from MIT.



# Le - Lo

## **Leung, Billy**

Regional Economic Models, Inc., USA  
Presenting in Session D1

Billy Leung holds a B.A. in Economics from the University of Massachusetts, Amherst and received his M.A. in Regional Economics and Social Development at the University of Massachusetts, Lowell. His master's thesis was on the research and development of incorporating transportation and land use with Input/Output economic modeling.

As an economist and consultant at REMI, Mr. Leung has developed economic research and analytical skills in regional economies and public policy issues including transportation, economic development, emissions, taxation, and counterfactual scenarios. He researched and developed the methodology to analyze the economic impact of Connecticut's Bradley International Airport for the Connecticut Economic Development Community Department. He analyzed the economic impact of a new Bio-Diesel industry in New York State for the U.S. EPA and researched the economic impact of widening New Mexico's US 54 for the New Mexico Department of Transportation.

Mr. Leung was promoted to Vice President at REMI in January 2009.

## **Long, Diana**

Rahall Transportation Institute, USA  
Moderating in SSession C3

Diana has been involved in the field of workforce development for over 35 years. Her expertise has been focused on the development and implementation of training programs to meet the needs of industry. She has experience in private education, public school education, Community and Technical College and higher education. Her education includes a BS in Education from Morris Harvey College Formal; a MS in Technical and Adult Education Administration from Marshall Unviersity and an Ed. D in Education Administration from West Virginia University.

She was the first educator in the state to complete the requirements for a Certified Economic Developer from the International Economic Development Association.

## **Lorenz, Julie Lorenz**

Burns & McDonnell Engineering Company, USA  
Presenting in Session B2

Julie Lorenz has 20 years experience in communication, public affairs and policy development in the transportation industry. Most recently, she served as Director of Public Affairs and Special Assistant to the Secretary for the Kansas Department of Transportation (KDOT), where she led strategic planning and integrated collaboration/communication efforts since 2003. Notably, KDOT secured an \$8.2 billion 10-year funding program in Spring 2010, resulting largely from stakeholder collaboration and an expanded project selection process which incorporates economic impact analysis.

Prior to joining KDOT, Ms. Lorenz was a public affairs and management consultant for the HNTB Corporation and URS for 12 years. She has a master's degree in Organizational Psychology from the University of Kansas and graduated from Drury College with degrees in Psychology and Business Administration. Ms. Lorenz currently serves as a Senior Strategic Consultant for Burns & McDonnell Engineering Company, headquartered in Kansas City.



**Madi, Marwan**

Booz Allen Hamilton  
Moderator for Session D1 and Session E2

Mr. Madi has more than twelve years of experience in transportation and logistics planning and public policy analysis. Mr. Madi serves clients in both the public and private sectors and has an extensive background in the fields of policy, strategic, innovative and public financing, economic development and analysis, and benefit/cost analysis. He led rail and logistics planning studies nationwide where he recommended innovative financing strategies to increase revenues and improve performance. Mr. Madi also assisted agencies nationwide on evaluating the impacts of new Federal and state legislation on transportation planning and investments. He also assisted agencies develop new and improved organizational strategies and implement new programs and policies.

At Booz Allen Hamilton, Mr. Madi is responsible for business development and growth in the areas of freight, supply chain, organizational strategy, and policy. He is supporting Booz Allen’s infrastructure team on various new and ongoing assignments pertaining to transportation infrastructure, logistics, policy, international trade, and economics. Mr. Madi is also involved in infrastructure, energy, and environment work opportunities overseas.

**Mann, Chris**

Co-Chair, Transportation and Economic Development Committee, TRB, USA  
Moderating in Session C1 and the Closing Session

Mr. Mann served as the Coordinator of Programming and Finance in the Transportation Programs of Southeast Michigan Council of Governments from 1983 to 2010. During his tenure Mr. Mann had lead responsibility for the management of the Regional Transportation Improvement Program (TIP) and project selection for federal-aid highway and transit funding programs. He directed professional staff in the development and implementation of financial planning for the Regional Transportation Plan and TIP. He was responsible for the coordination of project programming and financial planning activities for SEMCOG, local governments, regional transit agencies, and the Michigan Department of Transportation. Mr. Mann directed the development of policy for the TIP and conducted policy and financial analyses related to funding, financing, and costs of the transportation system. He directed the research, development, and integration of economic analysis into the transportation planning process. This entailed working with MDOT on the acquisition of the REMI model, and conducting economic impact analyses of proposed spending of federal, state, and local funds. He developed and presented educational programs and other outreach activities on finance, funding, and economic issues for state and local government. Mr. Mann’s background includes 28 years with the Southeast Michigan Council of Governments and an additional six years with transportation agencies at the local and county level. He has master’s degrees in urban and regional planning and economics. He is a co-chair of the Transportation Research Board’s Transportation and Economic Development Committee and past member of the Revenue and Finance and Economics committees. He is currently retired and residing in Troy, Michigan.



# Ma - Mo

## **Masingill, Chris**

Delta Regional Authority  
Presenting in the "All Star" Plenary Session



Christopher A. Masingill was sworn in as Federal Co-chairman of the Delta Regional Authority (DRA) on July 13, 2010.

Prior to joining the Obama Administration he served as Arkansas Governor Mike Beebe's Director of Intergovernmental Affairs, as well as the Arkansas Recovery Implementation Director for the American Recovery and Reinvestment Act of 2009. He served as the official liaison between the Governor's Office and the Arkansas Economic Development Commission, the National Governors Association, the Southern Governors' Association, the DRA, and the State Coordinators for Economic Recovery.

From 2001 to 2005, Masingill was the District Director for U. S. Congressman Mike Ross. Only 28-years-old when he began working in Congressman Ross's Office, Masingill was one of Congress's youngest district directors. Masingill also served as Special Projects Assistant for U.S. Senator Blanche Lincoln in Washington D.C. during the creation of the DRA, assisting in community- and economic-development projects.

Chris and his wife, Melissa, have two daughters, Mia and Ava, and reside in Little Rock.

## **McClellan, Eric**

Wilbur Smith Associates  
Presenting in Session D3

Eric has been evaluating the economic and financial implications of transportation investments for over 23 years across all modes of transport. In doing so, he has consulted a wide range of public and private sector clients with diverse needs across five continents.

Recent work includes: a financial feasibility analyses for a private Mongolian coal mining firm interested in building a railroad to transport coal; a financial and economic feasibility of an Electronic Toll Collection (ETC) and Intelligent-Transportation-System (ITS) for Bangkok; and a riverport feasibility and impact study along the Cumberland River in Tennessee.

In the conduct of dozens of economic impact and feasibility studies for all modes (highway, rail, port and airport), Eric has used a wide range of economic models including IMPLAN, REMI and TREDIS. Beyond the critical questions of whether or not society is "better-off" making transportation infrastructure investments, Mr. McClellan has conducted numerous financial analyses of the revenues and expenses associated with private-sector and public-private-partnerships (PPPs) to determine if, when and how a transport project can be developed so that it can generate sufficient revenues to cover expenses over a project life.

## **Mogensen, Brian Gardner**

Grontmij| Carl Bro A/S, Denmark  
Presenting in Session C3

Brian Gardner Mogensen received a Master in Economics from Roskilde University in Denmark. He has spent over a decade in the transportation-economics field including time with the Danish Ministry of Economic and Business, Danish Ministry of Transport, Danish Ministry of Business Affairs and more recently Grontmij|Carl Bro where he is an Analysis Manager responsible for the transport and socio-economic analysis unit "Transport Economics".

Brian has great insight and knowledge in weighing economic decision making in relation to transport investments - including the Ministry of Transport Terasa model. In recent years, he has focused on developing new analytical approaches and methods for dynamic effects in relation to transport investment. He also has experience providing strategic advice at a high political and administrative level in the public sector.

## **Moruz, Audrey**

Virginia Department of Transportation, USA  
Moderating in Session A2

Audrey Moruza is a Transportation Research Economist at the Virginia Center for Transportation Innovation and Research (VCTIR - the research arm of the Virginia Department of Transportation) in Charlottesville, Virginia. Her research over the last five years has ranged widely from road-damage-based permit fees for overweight and overload vehicles to analysis of the economic implications for VDOT of replacement of steel cable with carbon fiber composite cable in bridge rehabilitation and construction. Ms. Moruza is a member of the TRB Committee on Transportation and Economic Development (ADD10) and a friend of the TRB Committees on Taxation and Finance (ABE10), Transportation Economics (ABE20), and Congestion Pricing (ABE25). She recently joined the American Economic Association upon learning that it was a covered professional expense.

## **Moses, Susan Jones**

Susan Jones Moses and Associates, USA  
Presenting in Session D2

Susan Jones Moses is a city and regional planner with over twenty years of experience assessing the impacts of major transportation investment projects. For the past fourteen years, she has operated a woman-owned business specializing in the land use and economic impacts of highway and transit projects. She was a primary researcher for the SHRP 2 CO3 project, Interactions between Transportation Capacity, Economic Systems, and Land Use, for which she conducted over twenty and reviewed an additional 65 case studies of transportation investments throughout the United States to identify their economic development impacts. These case studies combined data analysis and information collected through interviews with transportation, economic development, and planning officials, and with local business leaders to calculate impacts. For a variety of state departments of transportation, business groups and civic organizations, she has conducted case studies of the impacts of interchanges and bypasses on economic growth, and the impacts of congestion on businesses. Her work also has included the evaluation of the economic and land development impacts of transit and airports.

Ms. Moses was a contributing author to NCHRP Report 456, Guidebook for Assessing the Social and Economic Effects of Transportation Projects, and NCHRP Synthesis 290, Current Practices for Assessing Economic Development Impacts from Transportation Investments. She also was the author of the transit-oriented development section of the Massachusetts Smart Growth Toolkit. Her firm, Susan Jones Moses and Associates, is a registered DBE with the US Department of Transportation, and a WBE with the states of Massachusetts, Rhode Island, Connecticut and Vermont. Prior to starting her own business, Ms. Moses was a principal and member of the Board of Directors of Cambridge Systematics, Inc., where she managed the firm's economic development practice.

## **Muhamad, Talha**

HDR, USA  
Co-Presenter in Session C1

Mr. Muhammad has 4 years experience in economic research and analysis. He has worked on various projects in transportation economics, regional economics, labor economics and risk analysis. He has a strong background in developing econometric models and conducting data analysis. Econometric models were used in the context of traffic and revenue studies as well as forecasting container trade at major US ports. Mr. Muhammad also conducted economic analysis for the National Cooperative Freight Research Program (NCFRP 11) into understanding freight demand drivers in the United States. His traffic and revenue work involved looking at major freight corridors including Indiana Toll Road, Pennsylvania Turnpike and the Ambassador Bridge. His travel demand modeling experience has included developing discrete choice models (using SP data) to develop predictive mode share modeling for various ferry studies. Previously, he was a Research Assistant at the National Bureau of Economic Research (NBER) where he conducted research in labor economics.



# Mw - Od

Recent publications include Freight and Passenger Modeling Using Hybrid Econometric – Network Models with Vilain et al. He has also served as a research assistant for publications in finance and labor economics.

## **Mwaklonge, Judith**

Prairie View A&M University, USA  
Presenting in Session B3 and Session C2

Dr. Judith Mwaklonge is a post doctoral researcher in the Department of Civil and Environmental Engineering at Prairie View A&M University. Her primary research interests include travel demand modeling, model transferability, and traffic operations. Dr. Mwaklonge's current work explores the use of Radio Frequency Identification (RFID) technology in transportation and climate change as it relates to transportation. She received her PhD degree in Civil Engineering in 2010 from Tennessee Technological University with her doctoral research focusing on travel demand modeling with multiple independent travel survey datasets.

## **Natzke, Stefan**

National Systems and Economic Development, FHWA, USA  
Moderating in Session D3

Stefan Natzke is the Team Leader for National Systems and Economic Development at the Federal Highway Administration (FHWA). Among its responsibilities, this office examines how transportation investments influence local or regional economic growth.

Stefan has held a variety of policy and planning positions at the U.S. Department of Transportation, in the areas of congressional affairs, intermodal and freight planning, and economic research into efficient goods movement and the national- and industry-level impacts of highway investment.

Prior to government service, Stefan worked for A.T. Kearney, Inc., an international management consulting firm, on various environmental economics projects, including social cost estimation and regulatory impact analysis for numerous U.S. Federal agencies.

He holds a Master of Urban Planning degree from the University of Michigan.

## **Odeleye, Joshua**

School of Transport, Nigeria  
Presenting in Session A1

Dr Joshua Odeleye specialises in Transportation Planning and Management. He has been able to build a career, which span over a decade, in the Nigeria transportation sector. Odeleye was formally a Traffic officer in the Nigerian Railway Corporation, prior to moving to the Nigerian Institute of Transport Technology, (NITT), Zaria, a specialized research and training institute under the Federal Ministry of Transport. While in NITT, he lectures and participated in various interdisciplinary transportation research projects. Presently, he is on leave of absence at the Lagos State University School of Transport, Lagos, Nigeria

The negative impacts of transportation on the global environment informed his keen interest in public transportation, as it relates to sustainable mobility planning and management globally. Odeleye has participated and presented papers at some international conferences that treated diverse subject of Sustainable transport planning.

Odeleye has successfully contributed to many transportation conferences. Among these are: World Congress of Transport Research Society (WCTRS), Berkeley, California, USA, 2007, 13th World Congress on Intelligent Transportation Systems (ITS), 2006, London, United Kingdom, Institute of Transportation Engineers (ITE) 2003 Technical Conference and Exhibit Compendium, 2003, Florida, USA, Energy, Environment and Development: Analysing opportunities for reducing Poverty conference, organized by TERI and IDDRI, Bangalore, India, 2006 to mention a few.

# Og - PI

Odeleye has a Bachelor of Arts degree in Classical Studies from University of Ibadan, Post-Graduate Diploma and Master of Science degree in Transportation Studies from Olabisi Onabanjo University, Ago-Iwoye; and Ph.D in Transportation Geography from the University of Lagos, Nigeria. He is a member of World Conference of Transport Research Society, Lyon, France; as well as a Chartered Member of Institute of Logistics and Transport (CILT), United Kingdom.

## **Ogonowski, Peter**

Willbur Smith Associates, USA  
Moderating in Session C2

Mr. Ogonowski is a Senior Economist and Project Manager with the Economics Division of Willbur Smith Associates (WSA), and is based in Orlando. Mr. Ogonowski specializes in economic/financial feasibility, economic impact and development, and macroeconomic analyses related to various transportation infrastructure projects domestically and internationally.

Prior to joining WSA, Mr. Ogonowski worked as an economist and project manager at Transportation Economics & Management Systems (TEMS), Inc. at the company's main office in the Washington D.C. Metro area, where he performed various feasibility and other types of transportation studies throughout the U.S. and Canada.

Mr. Ogonowski earned a Masters Degree in Economics from York University, has an Honors Bachelors Degree in Economics, Urban & Economic Geography, and Criminology from the University of Toronto, and is currently earning a Ph.D. in Business, and is a Licensed International Financial Analyst (LIFA) Charterholder.

## **Paciulli, Melissa**

University of Massachusetts, USA  
Presenting in Session B2

Melissa Paciulli, MSCE is the Program Manager for the Massachusetts Cooperative Research Program (MCRP), at the University of Massachusetts Transportation Center in Amherst, MA. At the MCRP, Melissa provides oversight and management of transportation engineering research, acting as an intermediary between the University system and the MassDOT. She is an active member of the TRB Conduct of Research Committee as well as the Transportation and Economic Development Committee, and has recently started the first WTS Boston Student Chapter UMass Amherst, of which she is President.

In addition to her professional pursuits, Melissa is a PhD candidate in the Transportation Engineering Program at UMass, where her research is focused on transportation systems and infrastructure and their economic development impacts.

## **Plazak, David**

SHRP2 Staff, TRB, USA  
Presenting and Moderating in Session D2

David Plazak is a Senior Program Officer with the 2nd Strategic Highway Research Program (SHRP 2) at the Transportation Research Board in Washington, DC. He manages SHRP 2 projects related to Highway Capacity. His previous work experience was with the Center for Transportation Research and Education at Iowa State University where he specialized in access management-related research and taught transportation planning and policy courses. Prior to that, he operated his own consulting practice and worked for the Iowa Departments of Economic Development and Transportation. He is a member of the American Institute of Certified Planners (AICP).

# PI - Ra

## **Plymale, Robert**

Rahall Transportation Institute, USA  
Presenting in the Opening Session



Since 2001, Robert H. Plymale has served as Director and CEO of the Nick J. Rahall, II Appalachian Transportation Institute. Under his direction, RTI has grown to become a National University Transportation Center and received millions of dollars to complete research projects related to the enhancement of the 13 states in the Appalachian Region and the nation. Focusing on Appalachia's road, river and rail systems, and with plans to expand into aviation, RTI strives to improve the safety of those systems and increase the region's economic development potential.

Bob has extensive legislative experience at both state and national levels. He is currently serving his fourth four-year term in the West Virginia state Senate, representing District 5, which consists of western Cabell and Wayne Counties. He is Chairman of the Senate Education Committee, the Senate Committee on

Transportation, the Senate Committee on Pensions. He is also Chair of the Select Committee on the Public Employee Insurance Agency, Co-Chair of the Forest Management Review commission and member of the Coal Truck Overweight Task Force.

On the national level, Plymale was appointed by Governor Bob Wise in 2003 to the Southern Regional Education Board's Board of Control and reappointed in 2006 by then Governor Joe Manchin. He now serves on the executive committee. In 2004-05, he became a member of the National Conference of State Legislatures (NCSL) National Task Force on "No Child Left Behind" and from 2005-2006, he was Chair of NCSL's Education Committee and the NCSL Blue Ribbon Commission on Higher Education.

In 2000, Bob received a Distinguished Service Award from the West Virginia Athletic Directors Association. In 2004, he received a Presidential Citation from Glenville State College and the Michael Pretera Award of Excellence in recognition of contributions made in improving the lives of those with behavioral health issues. In 2005, Bob received the Distinguished Service to the Community Award from Marshall University. Recently Plymale became Co-President of the Keith Albee Theater Performing Arts Center, Inc. and he has been instrumental in reviving and maintaining this Huntington landmark as a performing arts and community center. Most recently, the National Trails Association awarded its 2010 Trails Public Service Awards to Plymale for his demonstration of significant and consistent support of trail planning, design, or implementation through strong leadership and legislative efforts.

## **Rafiah, Rimon**

Managing Director, Economikr, Israel  
Presenting in Session D2

Rimon Rafiah has been an international economic consultant for nearly two decades. During his career, he has performed economic evaluations on proposed transportation investments spanning the USA, Europe, Latin America, the Caribbean, Africa, and Israel. He has provided economic consulting services and expertise to the following clients on five continents: FHWA, FRA, the World Bank, the Interamerican Development Bank, Economic Development and Research Group, coupled with national governments, local governments, public institutions, and private companies. He has also performed statistical analyses on many kinds of transportation projects, which is the focus of the current SHRP2 paper.

Rimon is an experienced lecturer, guest speaker and published author with numerous papers to his credit, including: "PPP Implementation within a Pavement Management System for Nigeria," presented at the ICMAPA2008 (International Conference on Managing Pavement Assets), "The Cost of Highway Limitations and Travel Delay to Oregon's Economy," for the Oregon Business Alliance (performed with EDR Group), "Multi-Year Economic Optimization of Transportation Projects," presented at the previous TED Conference in Little Rock, the "Economic Evaluation of TYDRIP," at a Conference on the Ten-Year District Road Investment Plan (TYDRIP)

# Ra - Re

for 30,000 km. of the Ugandan Rural Road Network, and "International Sectorial R&D Spillovers and Country Growth," presented at Tel Aviv University.

Rimon is a member of two TRB (Transportation Research Board) committees on Transportation Economics, and on Transportation and Economic Development. He holds a Master's degree in Economics from Tel Aviv University and a B.A. in Economics (Cum Laude), from The Hebrew University of Jerusalem. He currently resides in Israel.

## **Rahall, Nick**

Representative, US Congress

Presenting in the Opening Session

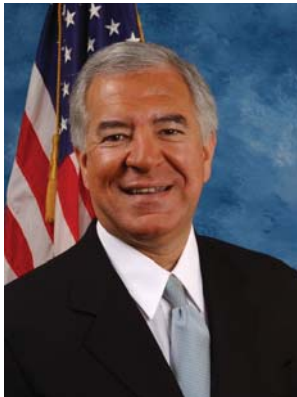

U.S. Rep. Nick Rahall of Beckley represents the Third Congressional District of West Virginia. First elected in 1976, he is currently serving his 17th term and is the Dean of the West Virginia Delegation to the U.S. House of Representatives.

Rahall is well known for his expertise in national policies relating to transportation, and infrastructure, energy and the environment. In addition, he is a tireless fighter for the Appalachian Regional Commission, black lung benefits, veterans' benefits, and mine health and safety issues. In the House of Representatives, Rahall is the Chairman of the Committee on Resources and is Vice Chairman on the Committee on Transportation and Infrastructure.

In the area of transportation and infrastructure, Rahall is a national leader in the development of federal highway and transit legislation. He serves on two Transportation and Infrastructure subcommittees: Highways and Transit; and, Railroads, Pipelines, and Hazardous Materials. A veteran of every federal highway bill since coming to Congress, Rahall chaired the House Subcommittee on Surface Transportation in the 103rd Congress and was the Ranking Democratic Member on the Ground Transportation Subcommittee during the 104th through 106th Congresses.

## **Ratanawaraha, Apiwat**

Chulalongkorn University, Thailand

Presenting in Session E3

Apiwat Ratanawaraha is an Assistant Professor at the Department of Urban and Regional Planning, Chulalongkorn University in Bangkok, Thailand, where he teaches infrastructure planning and finance, urban management, and technology policy and economic development. His current research includes projects on city innovations in Southeast Asian megacities, on infrastructure justice, on spatial inequality in Thailand, and on technological standards. He holds a Ph.D. in Economic Development and Technology Policy from MIT. He has been a Visiting Assistant Professor at the Department of Urban Studies and Planning at MIT, teaching infrastructure finance and energy security. He was a Doctoral Fellow at the Belfer Center for Science and International Affairs, Kennedy School of Government, Harvard University, conducting research on infrastructure, technological development and innovation policy for the United Nations Task Force on Science, Technology and Innovation.

## **Reid, Robena**

United States Department of Transportation, USA

Presenting in Session C1

Robena Reid joined the FTA Office of Policy Development in 1999 as a Financial Economist. She has performed a variety of financial management roles including credit analysis, lending program oversight, and loan negotiation for the Transportation Infrastructure Finance and Innovation Act (TIFIA) program and the State Infrastructure Bank program.

Ms. Reid received her Master of Business Administration and Master of Science in Finance degrees from Bentley College; she received a Bachelor of Arts degree from Smith College.

# Re - Ro

## **Reno, Arlee**

Cambridge Systematics, USA  
Presenting in Session A2

Arlee T. Reno is a Senior Vice President of Cambridge Systematics with more than 35 years of experience assisting government agencies in solving their most pressing problems in transportation economic analysis, finance, operations, policy, and planning. He led an analysis for FHWA of how to integrate the use of benefit-cost analysis into a proposed multimodal national and state performance management framework, and detailed the use of economic analysis methods around the world. With Mr. Glen Weisbrod, he recently summarized for TCRP the overall benefits of public transportation capital and operating investments, including user benefits, jobs, and long term productivity. Mr. Reno has conducted evaluations for the AASHTO Bottom Line reports of the national highway and transit investment needs which are economically justified to support both current and previous federal authorization legislation. He has conducted similar investment needs analysis for many states and regions. He has assisted the National Cooperative Highway Research Program (NCHRP), the National Surface Transportation Policy and Revenue Study Commission, and many states and urban areas in major studies of multimodal revenue alternatives, including evaluations of new and innovative sources. Mr. Reno is author of the Characteristics of Urban Transportation Systems (CUTS), the nation's basic reference on transportation supply parameters. Mr. Reno received both a Master's degree in City Planning and a Bachelor of Science degree from the Massachusetts Institute of Technology.

## **Rockefeller, Jay**

Senator, US Senate,  
Presenting in the Opening Session



Senator Jay Rockefeller has proudly served the people of West Virginia for over 40 years. Rockefeller first came to West Virginia in 1964 as a 27-year-old VISTA volunteer serving in the small mining community of Emmons. Many of the lessons that Rockefeller learned in Emmons have shaped his public service career and led to his life-long commitment to improving the lives of West Virginians and all Americans.

To diversify and expand economic opportunities, Rockefeller has played an instrumental role in attracting new investment and jobs to West Virginia. In addition to bringing a Toyota manufacturing plant to Buffalo, Rockefeller has recruited numerous national and international companies to the Mountain State, resulting in thousands of new jobs. At the same time, Rockefeller maintains a strong focus on strengthening core industries such as steel, coal and chemicals by fighting for fair trade policies and targeted tax relief. He is also working on policies that will allow for energy independence by drawing on West Virginia's natural resources to produce clean and reliable fuels.

Senator Rockefeller is the Chairman of the Senate Committee on Commerce, Science, and Transportation. He is also the Chairman of the Health Care Subcommittee on Finance; and a member of the Senate Select Committee on Intelligence. He also serves on the Senate Committee on Veterans' Affairs.

Since 1967, Rockefeller has been married to Sharon Percy Rockefeller with whom he has four children: John, Valerie, Charles, and Justin. Jay and Sharon are also the proud grandparents of four granddaughters and two grandsons.

## Ruffalo, Kathy

Ruffalo and Associates, LLC  
Presenting in the Opening Session



Kathy Ruffalo is a government affairs consultant who has had a broad, diverse, and bi-partisan career in public policy with 16 years of experience at both federal and state levels of government. From 1989 to 1999, Ms. Ruffalo served as a senior advisor to the United States Senate Environment and Public Works Committee - reporting directly to the Committee Chairman, Senator Max Baucus. She had the primary responsibility for developing, drafting and negotiating all aspects of federal surface transportation policy. During that timeframe, she worked on three major pieces of transportation legislation.

From 1999 to 2004, Ms. Ruffalo was a Senior Policy Advisor to Idaho Governor Dirk Kempthorne - currently the United States Secretary of the Interior. During her tenure, she was responsible for developing state policy related to transportation, economic development, international trade, adult/juvenile corrections and law enforcement.

In 2005, Ms. Ruffalo returned to Capitol Hill at the request of Congressional leaders to work on the latest transportation legislation. She has been appointed by the United States Congress to be a member of the National Surface Transportation Infrastructure Financing Commission. Since leaving Capitol Hill, Ms. Ruffalo began a government affairs consulting practice.

She has a range of professional expertise - covering highway, transit, transportation safety, environmental and transportation tax/financing issues. Ms. Ruffalo is a 1989 graduate of Northwestern University with a Bachelor of Science degree in Industrial Engineering and Management Sciences.

## Skolnik, Jon

Jack Faucett Associates, Inc., USA  
Moderating in Session A1 and B1

Skolnik is Vice President and a Senior Economist at JFA. He is an economic policy analyst with 30 years of specialized experience in the development of economic data and models used in federal policy analysis. He has spent his career developing economic input-out models and has extensive experience in applying these models to the transportation and energy sectors. Skolnik has a Bachelor of Arts in Economics from the University of Wisconsin - Madison and a Masters of Public Policy degree from Georgetown University.

## Steele, Chris

CWS Group, USA  
Co-Presenter in Session E2

Chris Steele, President of CWS Consulting Group, has almost 20 years of experience in location strategy and real estate consulting. His background in a small city planning firm, a Big-Four consulting services firm (Ernst & Young LLP), and a world-class engineering and supply chain company (TranSystems Corporation) have resulted in a unique perspective on how the concept of place impacts business and community success around the globe. He has worked on projects as high-profile as Boeing's selection of Chicago for its Headquarters, and as everyday as a food processing expansion in rural West Virginia. Past clients include BlueCross Blue Shield of Massachusetts, Lenovo, Watermark Sports/Yakima, ADP, JP Morgan Chase, Sanofi Aventis, Jafza International Economic Zone, Becton Dickinson, HCA Healthcare, Atlas Copco and Biogen IDEC. Chris holds a BA from Rutgers University and a Masters in Regional Planning from the University of North Carolina at Chapel Hill.



# Ta - Th

## **Tadej, Peggy**

Northern Virginia Regional Commission, USA  
Moderating in Session A3

Peggy Tadej is the Northern Virginia Regional BRAC Coordinator for the Northern Virginia Regional Commission. Ms. Tadej will lead the efforts, on behalf of the Commission's member governments, to collaborate and coordinate the BRAC realignment within the region. Ms. Tadej has over 20 years of experience in transportation, economic development, and environmental issues at the local, regional, and national level. Ms. Tadej brings perspectives from public, private, and non-profit sector positions ranging from policy, program management, business development, market research, and program planning. Ms. Tadej most recently served as the Transportation Research and Technology Development Project Manager for the District Department of Transportation (DDOT). She was the Director of Research and Grants while at National Association of Regional Councils. She directed business development efforts for intelligent transportation systems (ITS) applications for three defense companies. Ms. Tadej was a founding member of the ITSVA and ITSMD state chapters, and has held officer positions in both organizations. Ms. Tadej earned her master's in Public Administration from the Long Beach California State University. You can contact Ms. Tadej at [peggy.tadej@novaregion.org](mailto:peggy.tadej@novaregion.org) or 703-642-0700.

## **Thompson, Lloyd**

Moffatt & Nichol, Inc., USA  
Presenting in Session A4

Lloyd Thompson has handled a broad range of goods movement's projects ranging from port trade forecasts to project financial modeling and analysis. He has developed in-depth expertise in port and intermodal market estimation and analysis as well as the analyses, planning and implementation of various port-related intermodal distribution projects. As a nationwide expert in these fields he has been invited to speak at many industry conferences sponsored by MARAD, the Journal of Commerce and the MARE Foundation. Mr. Thompson recently led Moffatt & Nichol's efforts in support of the Appalachian Regional Commission's multi-year project "Network Appalachia". This effort incorporated the participation of a study team comprised of representatives of each of the 13 Appalachian states, as well as hundreds of industry and government experts at four regional workshops. The recently published report crafts a strategic approach for enhancing the capacity of the region's goods movement infrastructure to improve Appalachia's connections with the global trade economy.

Prior to joining Moffatt & Nichol, MR. Thompson held a variety of positions at the Port Authority of New York and New Jersey, including leadership roles in internal consulting and capital and operations budget planning. He also managed the evaluation of PANYNJ programs, departments, and facilities in terms of efficiency, effectiveness, value and consistency with mission, on behalf of the Executive Director, including reviews of World Trade Center operations and consideration of Newark International Airport privatization opportunities.

Other representative project experience includes: Appalachian Regional Commission Network Appalachia, Port Inland Distribution Network Port Authority of New York and New Jersey, Port of Albany Master Plan, Port of Long Beach Middle Harbor Development Feasibility, West Vancouver Freight Access Project Financial Assessment, Philadelphia Regional Port Authority Strategic Facilities Assessment, Jasper Ocean Terminal Preliminary Business Case, Due Diligence MTC Holdings Acquisition, Business Plan Study Terminal 6 Port of Portland OR, Ten-Year Master Plan Port of Montreal Quebec Canada, Alameda Corridor Intermodal Container Distribution Study Port of Los Angeles & Long Beach CA, Contingency Capacity Planning & Operational Needs Port of New York & New Jersey, Feasibility Study CNY Distribution Hub New York, Port Newark Container Terminal Market Study Newark NJ, Evaluation of Goods Movement TX, Charleston Naval Base Container Terminal Charleston SC, Strategic Business Plan Port of Savannah GA, Midwest Marine Container Study Port Authority of New York and New Jersey, Brooklyn Piers 6-12 Redevelopment Project New York, Chicago-land Region Environmental & Transportation Efficiency (CREATE) Project Association of American Railroads, Port User Free Analysis, major US Metropolitan Port (Confidential Client), Regional Port Warehousing Functions & Business Plan, Metropolitan Region Analysis New York, Strategic Development Plan Market Analysis Port of Mobile Alabama, and the Fort Madison Bridge Replacement Project Iowa.

## **Turnoy, Scott**

Mid-Columbia Economic Development District (MCEDD) in The Dalles, Oregon, USA  
Presenting in Session A3

Scott Turnoy is the Project and Mobility Manager for the Mid-Columbia Economic Development District (MCEDD). His primary focus is to increase access to public transportation through enhanced coordination of services for special needs users in the region. Scott works directly with transportation providers in Klickitat and Skamania Counties in Washington, and Hood River, Wasco, and Sherman Counties in Oregon through the Gorge TransLink Alliance. Prior to working for MCEDD, Scott worked with the University Of Oregon Economic Development Center to conduct a statewide economic development needs assessment of Oregon communities. Scott previously served as planning intern for the City of Junction City and Social Science Analyst for the United States Forest Service in the Pacific Northwest Research Station. Scott is a graduate of Whitman College and received a Master of Community and Regional Planning from the University of Oregon.

## **Vadali, Sharada**

TTI, USA  
Presenting in Session C3

Dr. Sharada Vadali is an Economist at Texas Transportation Institute, Texas A&M University. Her research interests and experience include a wide range of economic policy issues, economic impact analysis of transportation investments, benefit cost analysis, performance and efficiency measurement in service sectors like the transportation industry, and pricing and finance in transportation. She has conducted research for several organizations including Texas Department of Transportation, National Cooperative Research Programs, University Transportation Centers, Center for Intelligent International Transportation Research as well as some MPO's. She is affiliated with several Transportation Research Board Committees, Transportation and Economic Organizations. Some of her research has appeared in journals including Journal of Applied Econometrics, TRB's Transportation Research Record series, Annals of Regional Science, World Road Association-PIARC. She is a member of Transportation and Economic Development and Social and Economic Factors committees of Transportation Research Board.

## **Viegas, Jose Manuel**

Instituto Superior Tecnico, Portugal  
Luncheon Speaker



José Viegas is a Full Professor in Transportation at the Department of Civil Engineering and Architecture of the Instituto Superior Técnico, since 1992. Founder and Chairman of the Board of TIS.pt, consultants in Transport, Innovation and Systems, s.a., 2000- Researcher at CESUR (Research Centre for Urban and Regional Systems, of the Technical University of Lisbon), since 1986.

## **Vilain, Pierre**

HDR, USA  
Presenting in Session C1

Dr. Pierre Vilain, Vice President at HDR, is an economist with 22 years of worldwide experience in regional economic policy formulation and advisory services, as well as in the transportation arena. His experience includes economic cost-benefit analysis, risk analysis and financial appraisal analysis and appraisal of major infrastructure projects, as well as transportation demand modeling. His specific skills include econometric and input-output modeling, quantitative risk analysis, and the extension of cost-benefit analysis techniques



# We

to integrate environmental and sustainability analysis in decision-making.

Dr. Vilain has developed industry and population forecasts for numerous clients. He has also developed population and employment forecasts for various clients nationwide, and has taught courses on regional economics and modeling for West Virginia University and for the Center for Urban Economic Development.

### **Wester, Ken**

Appalachian Regional Commission, USA  
Presenting in Session A4

ADHS (Appalachian Development Highway System) Program Manager for the Appalachian Regional Commission since May 2004; Work with ARC State DOTs and FHWA in the construction of the 3090 mile ADHS.

Retired from the Virginia Department of Transportation in May of 2004 after 33 years; Worked in Maintenance, Operations and Construction; Major Projects Dulles Toll Road Smart Tag, Northern Virginia Regional Computerized Signal System and Springfield Interchange \$28 Million Congestion Management Program.

Registered Professional Engineer in Virginia; Graduate of Virginia Military Institute with BSCE (1972), Masters Degree in CE (Transportation/Traffic Engineering) from University of Virginia (1975); Masters in Business Administration from Virginia Commonwealth University (1984).

### **Weisbrod, Glen**

EDR Group, USA  
Presenting in Session C2, Session E2 and the Closing Session



For the last 32 years, Glen Weisbrod has worked prominently around the world on the relationship of economic development to transportation, energy and technology development. This includes activities spanning Japan, Scotland, Australia, Italy, India, South Africa, Canada and the Netherlands, as well as around the US. Mr. Weisbrod has served Chair of the National Academies' TRB Committee on Transportation and Economic Development, and he previously served on the Board of Directors of the Council for Urban Economic Development. Mr. Weisbrod was also formerly Sr. Vice President of Cambridge Systematics, Inc. and Director of the Boston office of HBRS and Hagler Bailly Consulting. The author of over 30 published articles, he holds a MS in Engineering and MCP in Planning from M.I.T., and BA in Economics from Brandeis University.

His experience includes the following: Economic Development Impacts of Transport Projects & Programs, Economic Development Impacts of Environmental Regulations & Programs, Economic Development Impacts of Energy Programs, Evaluation of Economic Development Programs, Economic Development Impact of Other Public Policies and Investments, Economic Development Strategy, and Industry Market Studies.

### **Weiss, Martin**

Martin Weiss Consultants, USA  
Presenting in Session B1 and Moderating in Session E1

Mr. Weiss attended the Universities of Wisconsin and Nevada and served in the US Department of Transportation for 35 years ending in 2008. He worked in a dozen different offices in various generalist and specialist positions. He managed some of the larger discretionary grant programs as well as interstate designation. From about 1995 to 2008, he managed several transportation economic development studies and research programs including some pioneering before/after studies that led to the creation of the Delta Region Authority and others that were given prominence by the OECD. He was a member of the TRB Committee on Transportation and Economic Development and was the co-chair of the 2006 International Conference on the subject.

## **White, Karen**

Federal Highway Administration, USDOT, USA  
Presenting in Session B1

Karen White has over 15 years of experience as an Economist with the Federal Highway Administration's Office of Transportation Policy Studies. In this capacity Karen has been a lead in a number of research initiatives including measurement of the returns to the macro-economy and construction employment resulting from Federal-aid investment in highways, initiation of the new national highway construction cost index and truck size and weight analysis. Currently Karen is involved in analysis of mileage based user fee technologies, exploratory and advanced research into the role of risk preferences in route selection and evolution of real-time ride sharing technologies.

Before joining FHWA, Karen spent two years with Nathan Associates examining the economic impacts of monopoly pricing. Karen holds undergraduate degrees in Finance and Economics from the University of Texas at Austin and a Ph.D. in Economics from the University of Houston.

## **Winston, Cliff**

Brookings Institution, USA  
Presenting in the "All Star" Plenary



Clifford Winston, a Senior Fellow in the Brookings Institution's Economic Studies program, has been with Brookings since 1984. He is an applied microeconomist who specializes in the analysis of industrial organization, regulation, and transportation.

Winston has also been co-editor of the annual microeconomics edition of Brookings Papers on Economic Activity. Prior to his fellowship at Brookings, he was an Associate Professor in the Transportation Systems Division of the Massachusetts Institute of Technology's Department of Civil Engineering.

The author of numerous books and articles, Winston has published *Last Exit: Privatization and Deregulation of the U.S. Transportation System* (Brookings, 2010); *Government Failure versus Market Failure* (AEI-Brookings, 2006); *Deregulation of Network Industries: What's Next?*, with Sam Peltzman (AEI-Brookings, 2000); *Essays in Transportation Economics and Policy: A Handbook in Honor of John R. Meyer*, with Jose A. Gomez-Ibanez and William B. Tye (1999); *Alternate Route: Toward Efficient Urban Transportation*, with Chad Shirley (1998); *The Evolution of the Airline Industry*, with Steven A. Morrison (1995); *The Economic Effects of Surface Freight Deregulation*, with Thomas M. Corsi, Curtis M. Grimm, and Carol A. Evans (1990); *Road Work: A New Highway Pricing and Investment Policy*, with Kenneth A. Small and Carol Evans (1989); *Liability: Perspectives and Policy*, with Robert E. Litan (1988); *Blind Intersection? Policy and the Automobile Industry*, co-author (1987); and *The Economic Effects of Airline Deregulation*, with Steven Morrison (1986). His articles have appeared in such journals as the *American Economic Review*, *Econometrica*, *Review of Economics and Statistics*, *Journal of Economic Literature*, *Bell Journal of Economics*, and the *Rand Journal of Economics*.

Dr. Winston received his A.B. in Economics from the University of California at Berkeley in 1974, his M.Sc. from the London School of Economics in 1975, and his Ph.D. in Economics from U.C. Berkeley in 1979.

# Wr - Zi

## **Wray, Lyle**

Capital Region Council of Governments (CROG) in Hartford, Connecticut, USA  
Presenting in Session A3

Lyle Wray has long been involved in service improvement and performance measurement in state and local governments and nonprofits. As county administrator in Dakota County Minnesota the county implemented a management indicator reporting system and moved toward a performance budget. He has published a number of articles on service improvement including on "best practices reviews" for local government and the roles of citizens as partners in performance management in local government. Recently with co-authors he published the book "Results That Matter" that articulates a model of effective community governance involving service improvement, performance measurement and engaged community residents. At two national conferences in the past year he has presented on next steps for performance management in the state and local context and has taught performance budgeting for a national nonprofit organization on a number of occasions. Over the past several months Dr. Wray has served on information technology and e-government task force during the transition to Governor Dannel Malloy's administration and serves on the Legislative Majority Leader's working group on job growth and technology.

Since 2004 Dr. Wray has served as executive director of the Capitol Region Council of Governments. In this role, Dr. Wray serves as chief executive for this regional planning organization for Hartford, Connecticut and the 28 surrounding towns in transportation, community development, public safety and homeland security. The metropolitan regional population is approximately one million. Initiatives include: region wide municipal service sharing projects, regional geographic information system, cooperative purchasing online system, and contributions to state and regional outcomes measurement systems in workforce development, education and training, transportation systems and economic development.

Dr. Wray's past experience includes serving as director of Ventura County Civic Alliance, Ventura County Community Foundation where he staffed a regional program of the Ventura County Community Foundation to engage citizens in identifying and addressing significant regional issues in a county of 850,000 residents with projects including a state of the region indicators report, "Connecting the Dots" community conversations on regional issues, and community communications and presentations. And Dr. Wray has held the position of executive director for the Citizens League in the Twin Cities for 11 years. In this role, he served as chief administrative officer of a nonpartisan citizen-based regional public policy organization.

Other positions that Dr. Wray has held include County Administrator and Human Services Director for Dakota County, Minnesota and Division Director for quality assurance and protective services for the Minnesota Department of Human Services.

Dr. Wray holds a Bachelor of Arts, Master of Arts and PhD in Psychology from the University of Manitoba, Winnipeg, Canada. He completed the State and Local Government executive program at the Kennedy School of Government at Harvard University.



## **Ziv, Jean-Claude**

Conservatoire National des Arts et Metiers, France  
Presenting in Session C1 and the Closing Session

Professor Jean-Claude ZIV holds the Chair of Transport and Tourism at the Conservatoire National des Arts et Métiers, one of the largest and oldest academic institutions in France. Jean-Claude ZIV is an engineer from Ecole Centrale de Paris and a Ph-D in City and Regional Planning from Cornell University.

Jean-Claude ZIV is also a director at Veolia Transdev Transportation, the largest public transport operator in the world. He is the general secretary of CODATU, a society dedicated to public transport in developing countries.